

# KMT GENUINE PARTS

## FOR MAXIMUM PERFORMANCE



Cutting Heads



Diamond Orifices



Fittings & Tubing



Valve Repair Kits

2024 - 2025  
CATALOG



[kmtgenuineparts.com](http://kmtgenuineparts.com)

**KMT**  
WATERJET

FOR TECHNICAL SERVICE:

email: [kmtgenuineservice@kmtwaterjet.com](mailto:kmtgenuineservice@kmtwaterjet.com)

+1 800-826-9274, Press 2



**KMT Genuine Service is Closer Than you Think!**

## TO ORDER PARTS:

+1-800-826-9274, Press 1

+1-620-856-2151, Press 1

**Fax:** +1-620-856-2242

**email:** [kmtgenuineparts@kmtwaterjet.com](mailto:kmtgenuineparts@kmtwaterjet.com)

**Normal business hours are:**

7:00AM to 5:00PM Central Time

**After hours emergency help is available 24/7**



## ORDER KMT GENUINE PARTS ONLINE 24/7:

[kmtgenuineparts.com](http://kmtgenuineparts.com)

(Log-in required)



**KMT Genuine Parts** are guaranteed to be of the highest quality, ensuring that your investment is protected.

Our parts are stringently tested to deliver a healthier & more efficient waterjet system, giving you peace of mind.

## THE VALUE OF KMT GENUINE PARTS

- Imitation parts DO NOT meet our stringent requirements for **QUALITY** and **SAFETY**.
- Fewer break/fix scenarios saving downtime
- Any use of non-KMT Genuine Parts on KMT equipment may reduce component lifetimes, compromise safe failure modes, and could void the Warranty
- **Fast delivery--same-day shipping on most parts**

For your convenience, we have labeled all items in this catalog according to the pressure range of their application. The following color code applies:



The product has been designed for use with our ultra-high pressure PRO product series and is applicable at a pressure range of up to 90,000psi/6.200 bar



The product is applicable at a pressure range of up to 60,000psi/4.100 bar

**All dimensions in this catalog are in inch unless specified otherwise. The decimal notation can be converted as follows:**

0.25 = 1/4 inch

0.38 = 3/8 inch

0.56 = 9/16 inch

0.75 = 3/4 inch

KMT products are tested & meet ISO 9001 processes and procedures with specific requirements so that our products are designed to perfectly fit with minimal installation time and for maximize usage.



Please note that all technical details shown in this catalog are subject to change and pictures are similar.

# CONTENTS

## KMT Pumps Portfolio 6

### Intensifier Replacement Parts 8

Seal Assemblies	10
Cylinder Seals & Spacers	11
Repair Kits	11
Proximity Switch Kits	12
Hydraulic Cylinders & Heads	13
Pump Plungers	14
Liners	15
Backup Rings	16
Hydraulic Cartridge Seal Assemblies	16
Hydraulic Piston Assemblies	17
Cylinders	18
High Pressure Cylinder Nuts	19
Bushing Retainer Flanges	20
Retaining Rings	20
Miscellaneous	20

### Sealing Heads 21

Sealing Head Assemblies	22
Spacers	23
Sealing Heads	24
Glands	25
Repair Kits	26

### NEO Pump Kits 28

NEO 30 HP & 50 HP Kits	29
------------------------	----

### Cutting Heads 30

Cutting Heads	31
Cutting Head Assemblies	32

### Cutting Head Parts 33

AUTOLINE Cutting Head Assembly Components	33
Cap	34
Body	34
Wear Inserts	35
Spare Parts Kits	35
Abrasive Feed Tube Adapters	36
Abrasive Feed Tube Assembly	36
Knob Retainer	36
Abrasive Guard	36
IDE Retaining Nut	37
Focusing Tube Retaining Collet	37
Short Stop Adapter Assembly	37

### Orifices & Focusing Tubes 38

Orifices for 60,000psi Abrasive Cutting	39
Orifices for 90,000psi Abrasive Cutting	40
Orifices for 60,000psi Water-only Cutting	41
Orifices for 90,000psi Water-only Cutting	43
Focusing Tubes	44
SHAPE Delta Focusing Tubes	46

### Pneumatic Valves 48

Pneumatic Valve / Actuator Assemblies	50
---------------------------------------	----



# CONTENTS

Repair Kits  
51

Tool Kits  
52

Pneumatic Valve Bodies  
52

Actuators  
53

Nozzle Nuts  
54

Valve Glands  
55

Nozzle Tubes  
56

## HP Fittings & Tubing 59

Ultra-High Pressure Tubing  
60

High Pressure Tubing - Accessories  
62

High Pressure Fittings  
63

Check Valve Assemblies  
69

Inline Water Filters  
70

HP Water Filter Assemblies  
71

Swivel Joints  
72

Swivel Joints - Cap Assemblies  
72

Swivel Joints - Straight Bodies  
73

90 Degree Bodies  
74

Bushings  
74

Thrust Bearings  
75

Seal Assemblies  
75

Repair & Tool Kits  
76

Coning & Threading Tool Kits  
77

Threading Tool Assemblies  
78

Coning & Threading  
79

## Miscellaneous Parts & Supplies 80

LP Water Filter Components  
81

Hydraulic Oil Filter Components  
81

O-Rings for Sealing Heads  
82

O-Rings for Pneumatic Valves  
82

O-Rings for Topworks  
83

O-Rings for Cutting Heads  
85

O-Rings for Inline Filters  
86

Booster Pumps  
86

Hoses  
86

Gauges  
87

Electrical Components  
88

Light Bulbs  
89

Pressure Transducers  
89

Topworks Tools  
90

Lubricants  
92

The Value of PRO 90,000psi Cutting  
93

Frequently Ordered Parts & Notes  
94

# KMT PUMPS PORTFOLIO



125 HP



60 HP



200 HP



100 HP

## PRO SERIES | 90,000 PSI

### PRO SERIES | 90,000psi | LOWEST COST PER PART!

Available in 125 HP and 60 HP

The STREAMLINE PRO® Series Pumps significantly increase cutting productivity by 50 - 70% and use up to 50% less abrasive vs. industry standard 60,000 PSI/50 HP & 100 HP cutting.

### SL-VI SERIES | 60,000psi | THE PROVEN INDUSTRY WORKHORSE

Available in 200 HP, 100 HP, 50 HP and 15 HP

The STREAMLINE® SL-VI Series is a configurable designed waterjet pump that can be custom built based on a variety of options to meet your cutting solution requirements.

### CLASSIC SERIES | 60,000psi | RELIABLE PERFORMANCE AT A VALUE

Available in 50 HP and 30 HP

The STREAMLINE® CLASSIC Series employs long-stroke technology designed for ease of use, reliability and maximum uptime...*Classic KMT with modern technology!*

### TRILINE DIRECT DRIVE | 55,000psi | ECONOMICAL & DEPENDABLE CUTTING

Available in 30 HP

The TRILINE® pump has an excellent cost of ownership value and can be used as a stand-alone unit for everyday cutting needs.

# BROADEST RANGE OF WATERJET PUMPS



50 HP & 30 HP



50 HP & 30 HP



15 HP



30 HP

**STREAMLINE & CLASSIC SERIES | 60,000 PSI**

**TRILINE DD  
55,000 PSI**

## CUT WITH PRO 90,000 PSI FOR LOWEST COST PER PART!

The KMT Cut Calculator App 2.0 compares 90,000 PSI vs. 60,000 PSI cutting and shows the lowest cost per part results for your cutting application!

### MAXIMUM PERFORMANCE • MAXIMUM POWER • FASTEST CUTTING

The KMT App incorporates 25 materials, offers a wider range of substrate thicknesses, horsepower, orifice size and abrasive rates.

## KMT STREAMLINE PRO®. WORLD'S FASTEST WATERJET!



KMT Cut Calculator App 2.0



## INTENSIFIER REPLACEMENT PARTS

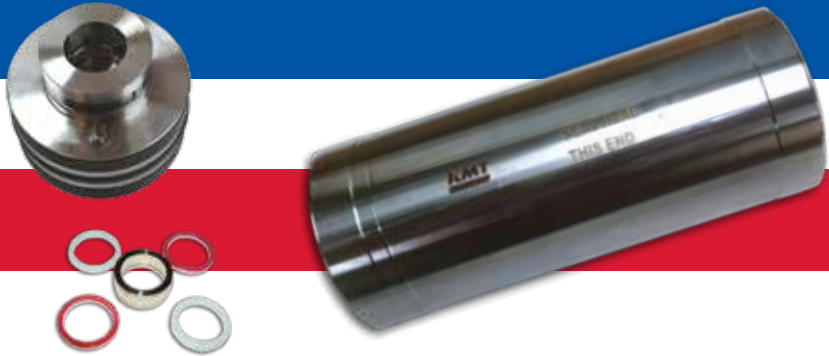

---

# Intensifier Replacement Parts

---

# KMT INTENSIFIER

## KMT Intensifier - The Source of Pressure

No other system incorporates the features of  
KMT Intensifiers to deliver the simplest,  
easiest-to-operate, most reliable system.



The KMT intensifier is the heart of your waterjet system and helps determine the quality and quantity of the products you make. The use of KMT Genuine Parts to maintain your intensifier helps maximize life and improves value.

KMT STREAMLINE PRO® intensifier replacement parts are available exclusively from KMT and require precision manufacturing to ensure the best performance from your STREAMLINE PRO® pump.

### KMT Intensifier Features:

- Plunger – KMT intensifiers use a longer pressurizing stroke than other manufacturers, thereby stroking less frequently for longer life.
- Seals – KMT's Hyperlife™ seals (U.S. Patent #6,769,695 and Sweden Patent #0203660-6) used in the Streamline topworks provides greater value than inferior, imitation parts.
- Metal-to-Metal Seal Head – Ensures positive sealing & the ability to re-use crucial components, saving you money.



# SEAL ASSEMBLIES

## DESCRIPTION

## PART No.

**UHP Seal Assembly - SUPRAlife, Canister  
.88 dia. plunger**

72158494

90,000psi/6,200 bar  
Used on PRO-III units with a 60 or 125 horsepower rating

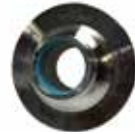

**UHP Seal Assembly - 0.88 dia. plunger**

20479499

90,000psi/6,200 bar  
Used on select SL PRO-I units with 60 or 125 hp rating



**HP Seal Assembly - 1.13 plunger units**

05149711

60,000psi/4,100 bar  
Used on all SL-V and SL-VI units with a 75 to 200 horsepower rating



**HP Seal Assembly - 1.13 plunger units, hybrid**

20467135

60,000psi/4,100 bar  
Used in some specialty applications on SL-IV Plus, SL-V and SL-VI 75 HP - 200 HP units



**HP Seal Assembly - 0.88 plunger units**

20422243

55,000-60,000psi, 3,800/4,100 bar  
Used on NeoLine SL-IV Plus 15hp - 60hp, SL-V 15hp - 60hp and SL-VI 15hp - 60hp units



**HP Seal Assembly - 0.88 plunger units**

05149703

55,000-60,000psi, 3,800/4,100 bar  
Used on SL-IV Plus units with a 15 - 60 hp rating.



**HP Seal Assembly - 0.88 plunger units**

05123385

55,000psi/3,800 bar  
Used in SL-IV units with a 15 to 50 HP rating



**HP Cylinder Seal Assembly - 0.88 plunger units**

05027172

55,000psi/3,800 bar  
Used on some SL-III and all SL-IV units



# SEALS, SPACERS & REPAIR KITS

## DESCRIPTION

## PART No.

### SEALS & SPACERS

- **Sealing Head Seal**  
 55,000psi/3,800 bar.  
 Used on SL-IV units
- **Sealing Head Spacer, 1.13 plunger units**  
 60,000psi/4,100 bar  
 Used on all SL-V units with a 75 to 200 horsepower rating
- **Sealing Head Spacer**  
 60,000psi/4,100 bar  
 Used on SL-IV Plus units with a 15, 30, 50 or 60 horsepower rating

10110393



05144597



05144696



### REPAIR KITS

- **Repair Kit - Hydraulic Piston PRO 90,000psi**  
 Kit includes retaining rings, bearings, o-rings, backup rings, seal assembly and check valves.

Repair Kit PRO-III

72168337

Repair Kit PRO-2

72168337

Repair Kit PRO-I

72168337



- **Repair Kit - Hydraulic Piston, 1.13 plunger units.**

55,000-60,000psi, 3,800-4,100 bar. Used on all SL-V and SL-VI units with a 75 to 200 horsepower rating. Kit includes retaining rings, bearings, o-rings, backup rings, seal assembly and check valves.

80085079



# REPAIR KITS

## DESCRIPTION

### Repair Kit - Hydraulic Piston, 0.88 plunger units.

55,000-60,000psi, 3.800-4.100 bar. Used on all SL-V and SL-VI units with a 15 to 60 horsepower rating. Kit includes retaining rings, bearings, o-rings, backup rings, seal assembly and check valves

### Repair Kit - HP Cylinder Assembly

Used on SL-IV, 55,000psi/3,800 bar. Kit includes seals, o-rings and backup rings to repair the HP cylinder seal and the sealing head seal.

## PROXIMITY SWITCH KITS

### Proximity Switch Kit SL-VI

55,000-60,000psi, 3.800-4.100 bar  
Used on all SL-VI units with a 15 to 50 horsepower rating

### Proximity Switch Kit - E50

55,000-60,000psi, 3.800-4.100 bar  
Used on all SL-IV, SL-V, Classic and OEM units with a 15 to 60 horsepower rating  
**Replaces Part #05127584**

### Proximity Switch Kit SL-VI

Used on all SL-VI 60,000psi/4.100 bar units with a 100-200 horsepower rating

Used on all 90,000psi/6.200 bar PRO units

### Proximity Switch Kit

Used on all SL-IV and SL-V 60,000psi/4.100 bar units with a 75-200 horsepower rating

Used on 90,000psi/6.200 bar PRO-1 and PRO-2 units

## PART No.

05115951



05115977



72146433



20453934



72141569



20453925



# HYDRAULIC CYLINDERS & HEADS

## DESCRIPTION

## PART No.

**Hydraulic Cylinder, 0.88 plunger HSEC units**  
 55,000-60,000psi, 3.800-4.100 bar  
 Used on all SL-IV, SL-V, Classic and OEM units with a 15 to 60 horsepower rating

05034764



**Hydraulic Cylinder, 1.13 plunger HSEC units**  
 55,000-60,000psi, 3.800-4.100 bar  
 Used on all SL-V units with a 75 to 200 horsepower rating and PRO units with a horsepower rating of 60 or 125. Replaces 05144514.

7219007434



**Hydraulic Cylinder Head, 0.88 plunger, HSEC units**  
 55,000psi/3.800 bar  
 Used on all Classic units with a 30 or 50 horsepower rating

20414880



**Hydraulic Cylinder Head, 0.88 plunger, HSEC units**  
 60,000psi/4.100 bar  
 Used on all SL-IV, SL-V and OEM units with a 15 to 60 horsepower rating

05034772



**Hydraulic Cylinder Head, 1.13 plunger, HSEC units**  
 60,000psi/4.100 bar  
 Used on all SL-V units with a 75 to 200 horsepower rating

20416445



# PUMP PLUNGERS

DESCRIPTION	PART No.	
<p> <b>Ceramic Plunger - 0.88 plunger units</b> 90,000psi/6.200 bar Used on all PRO-III units</p>	72162253	
<p> <b>Ceramic Plunger - 0.88 plunger units</b> 90,000psi/6.200 bar Used on all SL-VI PRO units</p>	72138164	
<p> <b>Ceramic Plunger - 0.88 plunger units</b> 60,000/90,000psi - 4.100/6.200 bar Used on all SL-V and SL-VI units with a 15 to 60 horsepower rating and on all PRO-I and PRO-2 units</p>	05119151	
<p> <b>Ceramic Plunger - 1.13 plunger units</b> 60,000psi/4.100 bar Used on all SL-V and SL-VI units with a 75 to 200 Horsepower rating</p>	05144506	
<p> <b>Carbide Plunger, 0.88 plunger units</b> 55,000psi/3.800 bar Used on all Classic and NL-I units with a 30 to 50 horsepower rating.</p>	05039771	



# LINERS

## DESCRIPTION

## PART No.

<p><span style="color: blue;">■</span> <b>Liner - UHP Cylinder, 0.88 plunger units, Stainless Steel</b>                      90,000psi/6.200 bar                      Used on all PRO-III with a 60 or 125 horsepower rating</p>	<p>72163802</p>	
<p><span style="color: blue;">■</span> <b>Liner - UHP Cylinder, 0.88 plunger units, Stainless Steel</b>                      90,000psi/6.200 bar                      Used on all PRO-2 with a 60 or 125 horsepower rating</p>	<p>72127441</p>	
<p><span style="color: blue;">■</span> <b>Liner - UHP Cylinder, 0.88 plunger units</b>                      90,000psi/6.200 bar                      Used on all PRO-1 and PRO-2 units with a 60 or 125 horsepower rating</p>	<p>20474333</p>	
<p><span style="color: red;">■</span> <b>Liner - HP Cylinder, 1.13 plunger units</b>                      60,000psi/4.100 bar                      Used on all SL-V and SL-VI units with a 75 to 200 Horsepower rating</p>	<p>72110945</p>	
<p><span style="color: red;">■</span> <b>Liner - HP Cylinder 0.88 plunger units</b>                      60,000psi/4.100 bar</p>	<p>20497767</p>	
<p><span style="color: red;">■</span> <b>Liner - HP Cylinder, 0.88 plunger units, Brass</b>                      60,000psi/4.100 bar</p>	<p>20491603</p>	

# BACKUP RINGS

## DESCRIPTION

## PART No.



### Hydraulic Piston Assembly Backup Ring

60,000/90,000psi - 4.100/6.200 bar  
Used on SL-IV, SL-V & OEM 7/8" plunger units with a 15 to 60 horsepower rating and PRO units with a horsepower rating of 60 or 125

05049994



### 5.25 x 5.50, 1.13 plunger units - Backup Ring

60,000/90,000psi - 4.100/6.200 bar  
Used on all SL-V and SL-VI (PRO) units with a 75 to 200 horsepower rating

05120092



### 3.75 x 4.0, 0.88 plunger units - Backup Ring

55,000-60,000psi, 3.800-4.100 bar  
Used on all SL-IV, SL-V and SL-VI units with a 15 to 60 horsepower rating.

05034855



## HYDRAULIC CARTRIDGE SEAL ASSEMBLIES



### 0.88 plunger units

60,000/90,000psi - 4.100/6.200 bar  
Used on all SL-IV, SL-V and SL-VI units with a 15 to 60 horsepower rating and all PRO units with a 60 or 125 horsepower rating

05130091



### 1.13 plunger units

60,000psi/4.100 bar  
Used on all SL-V and SL-VI units with a 75 to 200 horsepower rating

05146584



### 0.88 plunger units

55,000psi/3.800 bar  
Used on all Classic units with a 30 or 50 horsepower rating & NEOLINE 40 units

80086622



# HYDRAULIC PISTON ASSEMBLIES

## DESCRIPTION

### 1.13 plunger units

55,000-60,000psi, 3.800-4.100 bar  
 Used on all SL-V units with a 75 to 200 horsepower rating  
 Kit includes piston, retaining rings, bearings, o-rings, backup rings, seal assembly and check valves

### 0.88 plunger units

55,000-60,000psi, 3.800-4.100 bar  
 Used on all SL-IV, SL-V, Classic and OEM units with a 15 to 60 horsepower rating  
 Kit includes piston, retaining rings, bearings, o-rings, backup rings, seal assembly and check valves

### Seal Assembly - Hydraulic Piston, 0.88 plunger units

55,000-60,000psi, 3.800-4.100 bar  
 Used on all SL-V, Classic and OEM units with a 15 to 60 horsepower rating

### Bearing - Hydraulic Piston, 0.88 plunger units

55,000-60,000psi, 3.800-4.100 bar  
 Used on all SL-V, Classic and OEM units with a 15 to 60 horsepower rating

## PART No.

05146576



05132253



05117965



05117940



# CYLINDERS

DESCRIPTION	PART No.	
<p><b>PRO-III Cylinder - 0.88 plunger units</b>            90,000psi/6,200 bar            Used on all PRO-III units with a 60 or 125 horsepower rating</p>	72166738	
<p><b>PRO-2 Cylinder - 0.88 plunger units</b>            90,000psi/6,200 bar            Used on all PRO-2 and SL-VI PRO units with a 60 or 125 horsepower rating</p>	72121858	
<p><b>PRO-1 Cylinder - 0.88 plunger units</b>            90,000psi/6,200 bar            Used on all PRO-1 units with a 60 or 125 horsepower rating</p>	72121850	
<p><b>Cylinder - 1.13 plunger HSEC-C</b>            60,000psi/4,100 bar            Used on all SL-VI units with a 100 to 200 horsepower rating</p>	72154588	
<p><b>Cylinder - 1.13 plunger HSEC</b>            60,000psi/4,100 bar            Used on all SL-V units with a 75 to 200 horsepower rating  <b>Replaces Part #20473479 &amp; #20431076</b></p>	72119536	
<p><b>Cylinder - 0.88 plunger HSEC-C</b>            60,000psi/4,100 bar            Used on all SL-VI units with a 15 to 50 horsepower rating</p>	72160831	
<p><b>Cylinder - 0.88 plunger HSEC</b>            60,000psi/4,100 bar            Used on all SL-V and OEM units with a 15 to 60 horsepower rating  <b>Replaces Part #20479503 &amp; #05144647</b></p>	72119544	

# CYLINDERS

## DESCRIPTION

- **0.88 plunger**  
 55,000psi/3.800 bar  
 Used on SL-IV SSEC and NL-I units
  
- **0.88 plunger HSEC units**  
 55,000psi/3.800 bar  
 Used on all Classic units with a 30 or 50 horsepower rating. **Replaces Part #20434777**
  
- **0.88 plunger HSEC units**  
 55,000psi/3.800 bar  
 Used on all Classic version I units with a 50 horsepower rating. **Replaces Part #20414862**

## PART No.

05059712



72119529



72120023



## HIGH PRESSURE CYLINDER NUTS

- **HP Cylinder Nut - HSEC (Hard Seal End Cap) 0.88 plunger**  
 60,000psi/4.100 bar. Used on all SL-V and OEM units with a 15 to 60 horsepower rating
  
- **HP Cylinder Nut - SSEC (Soft Seal End Cap)**  
 55,000psi/3.800 bar. Used on all SL-IV units
  
- **1.125 HP Cylinder Nut, HSEC (Hard Seal End Cap)**  
 60,000psi/4.100 bar. Used on SL-IV Plus 75hp - 200hp, SL-V 75hp - 200hp, SL-VI 75hp - 200hp
  
- **UHP Cylinder Nut, HSEC (Hard Seal End Cap)**  
 90,000psi/6.200 bar. Used on PRO 2 units

80073646



05059688

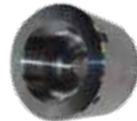

49838220



72101164





# BUSHING RETAINER FLANGES

## DESCRIPTION

## PART No.



### 0.88 plunger units

55,000-60,000psi, 3.800-4.100 bar  
Used on all SL-IV, SL-V, Classic & OEM units with a 15 to 60 horsepower rating

05007786



### 1.13 plunger units

60,000psi/4.100 bar  
Used on all SL-V units with a 75 to 200 horsepower rating

05145099



## RETAINING RINGS



### 1.011 x 0.030 x 0.118, Stainless Steel

90,000psi/6.200 bar  
Used on all 90,000psi/6.200 bar units

20492123



### 2.75, Stainless steel

60,000psi/4.100 bar  
Used on all 60,000psi/4.100 bar units

05034798



## MISCELLANEOUS



### Jackbolt - HSEC, 7/16-20 x 2.31

Used on all SL-V, Classic and OEM HSEC units

80070352



### HP Attenuator Assembly - 0.96L

Used on all 60,000psi/4.100 bar units.

05040696









## SEALING HEADS

# Sealing Heads



# SEALING HEAD ASSEMBLIES

DESCRIPTION	PART No.	
<p><b>0.88 plunger</b></p> <p>90,000psi/6,200 bar Used on all PRO-III units</p>	72170157	
<p><b>0.88 plunger</b></p> <p>90,000psi/6,200 bar Used on all PRO-2 and SL-VI PRO units</p>	20480087	
<p><b>0.88 plunger, 4 stud.</b></p> <p>90,000psi/6,200 bar Used on all PRO-I units</p> <p>Uses o-ring 10146082</p>	20480113	
<p><b>1.13 plunger units HSEC-C</b></p> <p>60,000psi/4,100 bar Used on all SL-VI units with a 100 to 200 horsepower rating</p>	72154603	
<p><b>1.13 plunger units HSEC</b></p> <p>60,000psi/4,100 bar Used on all SL-V units with a 75 to 200 horsepower rating</p>	72110979	
<p><b>0.88 plunger units HSEC-C</b></p> <p>55,000-60,000psi, 3,800-4,100 bar Used on all SL-VI units with a 15 to 50 horsepower rating</p>	72142526	
<p><b>0.88 plunger units HSEC</b></p> <p>55,000-60,000psi, 3,800-4,100 bar Used on all SL-V, Classic and OEM units with a 15 to 60 horsepower rating</p>	20481005	

# SEALING HEAD ASSEMBLIES

## DESCRIPTION

**0.88 plunger units**  
 60,000psi/4.100 bar  
 Used on SL-IV Plus flange units

**0.88 plunger units**  
 55,000psi/3.800 bar  
 Used on SL-IV units  
 Uses o-ring 05049853

**0.88 plunger units**  
 55,000psi/3.800 bar  
 Used on NL-1 units

## PART No.

05144688



05116769



20417081



# SEALING HEADS

DESCRIPTION	PART No.	
<p><b>0.88 plunger units</b></p> <p>90,000psi/6,200 bar Used on all sealing head assemblies for PRO-2 units</p>	72113373	
<p><b>0.88 plunger units</b></p> <p>90,000psi/6,200 bar Used on all sealing head assemblies for PRO-I units</p>	20479524	
<p><b>1.13 plunger units</b></p> <p>60,000psi/4,100 bar Used on all sealing head assemblies for SL-V units with a 75 to 200 horsepower rating</p>	72110961	
<p><b>0.88 plunger units</b></p> <p>55,000-60,000psi, 3,800-4,100 bar Used on all sealing head assemblies for SL-V, Classic and OEM units with a 15 to 60 horsepower rating</p>	20481009	
<p><b>0.88 plunger units</b></p> <p>60,000psi/4,100 bar Used on SL-IV Plus flange units</p>	05144357	
<p><b>1.13 plunger units</b></p> <p>55,000psi/3,800 bar Used on SL-IV units with a 15 to 60 horsepower rating</p>	10106417	
<p><b>0.88 plunger units</b></p> <p>55,000psi/3,800 bar Used on NL-I units</p>	20417000	

All dimensions in inch unless specified otherwise.



# GLANDS

## GLANDS

- **UHP Sealing Head, 0.88 plunger units**  
 90,000psi/6.200 bar  
 Used on all sealing head assemblies for PRO units
- **HP Sealing Head, 1.13 plunger units**  
 60,000psi/4.100 bar  
 Used on all sealing head assemblies for SL-V units with a 75 to 200 horsepower rating
- **HP Sealing Head, 0.88 plunger units**  
 55,000-60,000psi, 3.800-4.100 bar  
 Used on all sealing head assemblies for SL-IV, SL-V, Classic & OEM units with a 15 to 60 horsepower rating

### PART No.

20481660



05116595



05116777



# REPAIR KITS

## DESCRIPTION

## PART No.

**UHP Check Valve PRO (Inlet/Discharge) Ball Style Inlet/discharge, 0.88 plunger units**

72117819

90,000psi/6.200 bar  
Used on all PRO-2 and PRO-III units that utilize an inlet ball. Kit includes seat, discharge poppet, inlet ball, poppet pin, dowel pin & compression spring



**UHP Check Valve PRO-2, Discharge Kit, 0.88 plunger units**

72135447

90,000psi/6.200 bar  
Used on sealing head assemblies for PRO-2 units. Kit includes seat, discharge poppet, poppet pin & compression spring



**UHP Check Valve (Poppet Style) Inlet Inlet/discharge, 0.88 plunger units**

20477505

90,000psi/6.200 bar  
Used on all sealing head assemblies for PRO-I units that utilize an inlet poppet. Kit includes valve seat, inlet and discharge poppets, poppet pin and compression spring



**HP Check Valve, Discharge, 1.13 plunger units**

80084403

60,000psi/4.100 bar  
Used on all sealing head assemblies for SL-V units with a 75 to 200 horsepower rating. Kit includes valve seat, discharge poppet, poppet pin and compression spring



# REPAIR KITS

## DESCRIPTION

## PART No.

**HP Check Valve Discharge, 0.88 plunger units**  
 55,000-60,000psi, 3.800-4.100 bar  
 Used on all SL-V, Classic and OEM units with a 15 to 60 horsepower rating. Kit includes valve seat, discharge poppet, poppet pin and compression spring

05133335



**HP Check Valve, Inlet/Discharge, 1.13 plunger units**  
 60,000psi/4.100 bar  
 Used on all SL-V and SL-VI units with a *button style* poppet with a 75 to 200 horsepower rating. Kit includes valve seat, inlet and discharge poppets, poppet pin and compression spring

72125203



**HP Check Valve, Inlet/Discharge, 1.13 plunger units**  
 60,000psi/4.100 bar  
 Used on all SL-V units with *washer style* inlet with a 75 to 200 horsepower rating. Kit includes valve seat, inlet and discharge poppets, poppet pin and compression spring

20427747



**HP Check Valve, Inlet/Discharge, 0.88 plunger units**  
 55,000-60,000psi, 3.800-4.100 bar  
 Used on all SL-V and SL-VI units with a *button style* poppet with a 15 to 60 horsepower rating. Kit includes valve seat, inlet and discharge poppets, poppet pin, compression spring & poppet retainer screw

20489495



**HP Check Valve, Inlet/Discharge**  
 55,000-60,000psi, 3.800-4.100 bar  
 Used on SL-IV & SL-V units with a *washer style* inlet poppet. Kit includes valve seat, inlet & discharge poppets, poppet pin & compression springs

80074057



## NEO SERIES KITS



---

# NEO 30 HP & 50 HP Part Kits

---

# NEO SERIES KITS

**DESCRIPTION**  
 NEO 60,000psi-4.100 bar Pumps

**PART No.**

■ Check Valve Repair Kit - NEO 30 & 50 HP 1011158



■ Hydraulic Piston Repair Kit - NEO 30 & 50 HP 1011220



■ High Pressure Seal Repair Kit - NEO 30 & 50 HP 1011159



■ Dump Valve Repair Kit - NEO 30 & 50 HP 05116017



■ 500h Maintenance Kit - NEO 30 & 50 HP 1011160



■ 1.000h & 2.000h Maintenance Kit - NEO 30 & 50 HP 1011161



■ 3.000h Maintenance Kit - NEO 30 & 50 HP 1011164



■ Water Filter Element Kit - NEO 30 & 50 HP 7219013575



■ Oil Filter Element - NEO 30 & 50 HP 05049689



# CUTTING HEADS

AUTOLINE® PRO  
ASSEMBLY



IDE® PRO  
ASSEMBLY

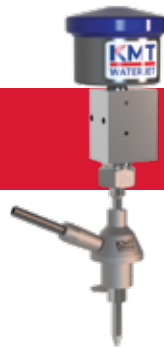

AUTOLINE® II  
ASSEMBLY



IDE® II  
ASSEMBLY

---

# Cutting Heads

---

# CUTTING HEADS

## DESCRIPTION

## PART No.

### IDE PRO Assembly

90,000psi/6.200 bar

#### Diamond Orifice

0.007" / 0.17 mm	20481407
0.008" / 0.20 mm	20481408
0.009" / 0.23 mm	20481409
0.010" / 0.25 mm	20481410
0.011" / 0.28 mm	20481411
0.012" / 0.30 mm	20481412
0.013" / 0.33 mm	20481413
0.014" / 0.35 mm	20481414
0.015" / 0.38 mm	20481415
0.016" / 0.40 mm	20481416
0.018" / 0.46 mm	20481418



### AUTOLINE PRO Assembly

90,000psi/6.200 bar, 0.75 UHP  
 (Orifice Assembly & Focusing Tube Not Included)

20480707



### IDE II Assembly - Without Short Stop Filter Element

60,000psi/4.100 bar

#### Diamond Orifice

0.007" / 0.17 mm	20477959007
0.008" / 0.20 mm	20477959008
0.009" / 0.23 mm	20477959009
0.010" / 0.25 mm	20477959010
0.011" / 0.28 mm	20477959011
0.012" / 0.30 mm	20477959012
0.013" / 0.33 mm	20477959013
0.014" / 0.35 mm	20477959014
0.016" / 0.40 mm	20477959016
0.018" / 0.46 mm	20477959018





# CUTTING HEAD ASSEMBLIES

## DESCRIPTION

## PART No.

### IDE II Assembly - With Short Stop Filter Element

60,000psi/4.100 bar

#### Diamond Orifice & Short Stop Filter

0.007" / 0.17 mm

20477950007

0.008" / 0.20 mm

20477950008

0.009" / 0.23 mm

20477950009

0.010" / 0.25 mm

20477950010

0.011" / 0.28 mm

20477950011

0.012" / 0.30 mm

20477950012

0.013" / 0.33 mm

20477950013

0.014" / 0.35 mm

20477950014

0.016" / 0.40 mm

20477950016

0.018" / 0.46 mm

20477950018



### AUTOLINE II Assembly

60,000psi/4.100 bar

#### 0.030 wear insert, 0.38 HP

(Orifice Assembly & Focusing Tube Not Included)

20453949

#### 0.043 wear insert, 0.38 HP

(Orifice Assembly & Focusing Tube Not Included)

20454108



### AUTOLINE I Assembly

60,000psi/4.100 bar

#### 0.030 wear insert, 0.38 HP

(Diamond & Focusing Tube Not Included)

05078530



## CUTTING HEAD PARTS

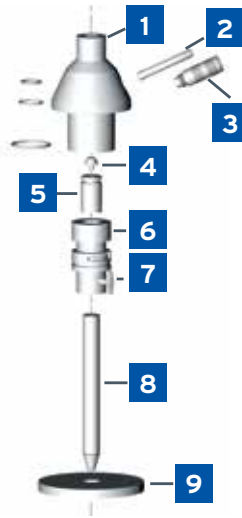

### AUTOLINE Components

- 1 Cap
- 2 Abrasive Feed Liner
- 3 Handle
- 4 Diamond Orifice
- 5 LONGLIFE Mixing Chamber
- 6 Nozzle Body
- 7 Wing Screw Focusing Tube
- 8 LONGLIFE Focusing Tube
- 9 Guard

---

# Cutting Head Parts

---

# CAP & BODY

## DESCRIPTION

### AUTOLINE PRO

90,000psi/6.200 bar  
0.75 UHP

For o-rings see pages 80-84

### AUTOLINE II

60,000psi/4.100 bar  
0.38 UHP

For o-rings see pages 80-84

### AUTOLINE I

60,000psi/4.100 bar  
0.38 UHP

For o-rings see pages 80-84

## PART No.

20480732



20453952



05076971



## Body

### AUTOLINE PRO

90,000psi/6.200 bar  
For o-rings see pages 80-84

### AUTOLINE II

60,000psi/4.100 bar  
For o-rings see pages 80-84

### AUTOLINE I

60,000psi/4.100 bar  
For o-rings see pages 80-84

20480715



20453958



05073820



# WEAR INSERTS

## DESCRIPTION

## PART No.

**AUTOLINE PRO**

90,000psi/6.200 bar

20454861



**AUTOLINE II**

60,000psi/4.100 bar

0.030, 25° Inlet (For o-rings see pages 80-84)

20453064

0.043, 25° Inlet

20453082

0.054, 25° Inlet

20454339



**AUTOLINE I**

60,000psi/4.100 bar

0.030, 45° Inlet, Tungsten Carbide

05076955

0.043, 45° Inlet, Tungsten Carbide

05135827

0.052, 45° Inlet, Tungsten Carbide

20442434



## SPARE PARTS KITS

**AUTOLINE PRO**

90,000psi/6.200 bar

Kit includes the setscrew and o-rings to service any AUTOLINE PRO assembly

20479589



**AUTOLINE II**

60,000psi/4.100 bar

Kit includes the setscrew and o-rings to service any AUTOLINE II assembly

20454129



**AUTOLINE I**

60,000psi/4.100 bar

Kit includes the setscrew and o-rings to service any AUTOLINE I assembly

05077367



# ABRASIVE FEED TUBE ADAPTERS

## DESCRIPTION



**AUTOLINE PRO & AUTOLINE II,**  
60,000/90,000psi-4.100/6.200 bar  
Stainless Steel



**AUTOLINE I**  
Stainless Steel



**IDE II & IDE PRO, 60,000/90,000psi-4.100/6.200 bar**  
Stainless Steel - Utilizes KMT part no. 10074870 O-ring,  
sold separately on page 85.

## PART No.

20453973

05076989

20454303



## ABRASIVE FEED TUBE ASSEMBLY



**AUTOLINE PRO & AUTOLINE II,**  
60,000/90,000psi-4.100/6.200 bar Includes  
10142610 O-ring.

20453964



## KNOB RETAINER



**AUTOLINE PRO & AUTOLINE II,**  
60,000/90,000psi-4.100/6.200 bar,  
Stainless Steel, T-Handle

20453976



**AUTOLINE I**  
Stainless Steel

05078712



## ABRASIVE GUARD



**AUTOLINE PRO, AUTOLINE II & I**  
60,000/90,000psi-4.100/6.200 bar

05087168



**90,000psi/60,000psi, KMT Cup Style**

72148276



# IDE RETAINING NUT

## DESCRIPTION

## PART No.



0.38, Stainless Steel, 60,000/90,000psi-4.100/6.200 bar

Used with IDE PRO and IDE II cutting heads

20454342

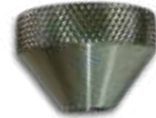

## FOCUSING TUBE RETAINING COLLET



0.373 ID, Brass, 60,000/90,000psi-4.100/6.200 bar

Retaining ring for IDE PRO and IDE II cutting heads

20454345



## SHORT STOP ADAPTER ASSEMBLY

Required when incorporating an IDE II cutting head into an existing system with a KMT pneumatic valve



Short Stop Filter Adapter, HP, 60,000psi/4.100 bar  
 0.25 M x 0.25 F

72169858



0.38 M x 0.25 F, High Pressure Tubing  
 60,000psi/4.100 bar

20454363



0.38 M x 0.38 F, High Pressure Tubing  
 60,000psi/4.100 bar

20454366



Short Stop Filter Element, 60,000/90,000psi-4.100/6.200 bar

20454426



Short Stop Filter Adapter, Ultra-high Pressure Tubing, 90,000psi/6.200 bar, 0.25 M x 0.25 F

7219014304



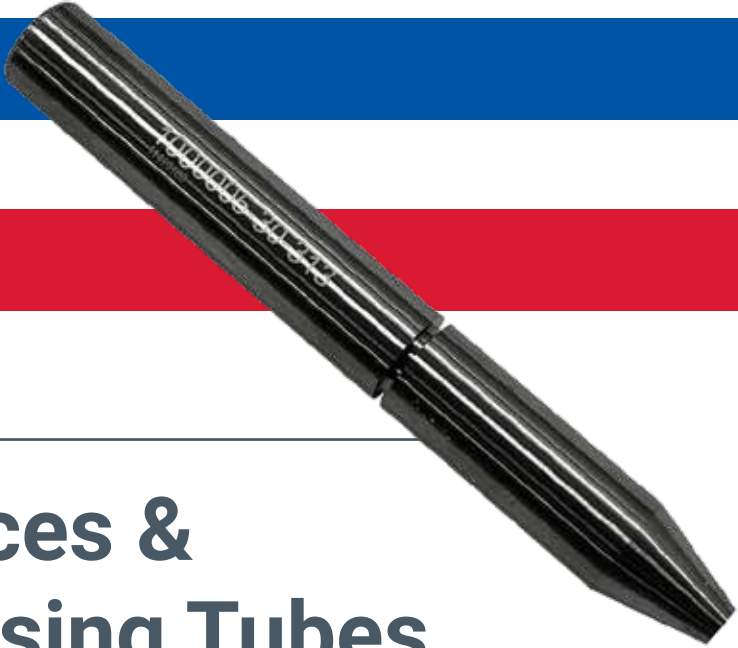

---

# Orifices & Focusing Tubes

---



# ABRASIVE ORIFICES/60,000PSI

## DESCRIPTION

## PART No.

### 60,000psi/4.100 bar Abrasive Cutting

#### Diamond Orifice, Autoline® I & II

0.004" / 0.10 mm	20448625
0.007" / 0.11 mm	05063847
0.008" / 0.20 mm	05112537
0.009" / 0.23 mm	05084504
0.010" / 0.25 mm	05077029
0.011" / 0.28 mm	05101753
0.012" / 0.30 mm	05077300
0.013" / 0.33 mm	05136098
0.014" / 0.35 mm	05077037
0.015" / 0.38 mm	80075781
0.016" / 0.40 mm	05121512
0.018" / 0.46 mm	05114905
0.019" / 0.48 mm	80086663
0.020" / 0.51 mm	05114897

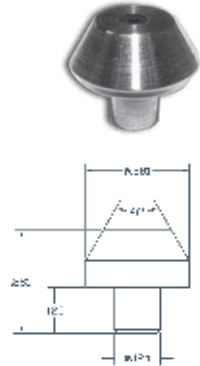

### 60,000psi/4.100 bar Abrasive Cutting

#### Sapphire Orifice, Autoline® I & II

0.007" / 0.17 mm	05109079
0.008" / 0.20 mm	05109087
0.009" / 0.23 mm	05109095
0.010" / 0.25 mm	05109103
0.011" / 0.28 mm	05109111
0.012" / 0.30 mm	05109129
0.013" / 0.33 mm	20412569
0.014" / 0.35 mm	05109137
0.016" / 0.40 mm	20448541
0.018" / 0.46 mm	05114913
0.019" / 0.48 mm	80086671
0.020" / 0.51 mm	05114921



# ABRASIVE ORIFICES/90,000PSI

## DESCRIPTION

## PART No.

### AUTOLINE PRO - ABRASVE

90,000psi/6.200 bar  
For True Alignment & Maximum Performance

#### Wear Insert Cartridge with Diamond Orifice

0.007" / 0.17 mm	20481607
0.008" / 0.20 mm	20496208
0.009" / 0.23 mm	20481609
0.010" / 0.25 mm	20496210
0.011" / 0.28 mm	20496211
0.012" / 0.30 mm	20496212
0.013" / 0.33 mm	20481613
0.014" / 0.35 mm	20496214
0.015" / 0.38 mm	20496215



**KMT Waterjet Abrasive Storage Hoppers save costs by protecting garnet and grit used for cutting hard materials like metal, stone, and composites.**



# WATER-ONLY ORIFICES/60,000PSI

## DESCRIPTION

## PART No.

**Orifices For Water-Only Cutting**  
 Standard Diamond, 60,000psi/4.100 bar

.003 (.076)	49888852
.004 (.102)	49888860
.005 (.127)	49888878
.006 (.152)	49888886
.007 (.178)	49888894
.008 (.203)	49888902
.009 (.229)	49888910
.010 (.254)	49888928
.012 (.305)	49888936
.013 (.330)	49836786
.014 (.356)	49888944
.015 (.381)	49888951
.016 (.406)	49888969
.018 (.457)	49888977
.019 (.483)	20436198
.020 (.508)	49888985
.022 (.559)	49888993

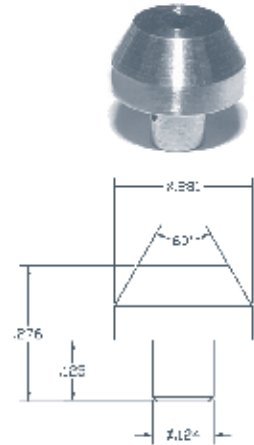

**Sapphire For Water-Only Cutting**  
 60,000psi/4.100 bar

.003 (.076)	A2260003
.004 (.102)	A2260004
.005 (.127)	A2260005
.006 (.152)	A2260006
.007 (.178)	A2260007
.008 (.203)	A2260008
.009 (.229)	A2260009
.010 (.254)	A2260010
.011 (.279)	A2260011
.012 (.305)	A2260012
.013 (.330)	A2260013
.014 (.356)	A2260014
.015 (.381)	A2260015
.016 (.406)	A2260016
.018 (.457)	A2260018
.019 (.483)	A2260019
.020 (.508)	A2260020
.022 (.559)	A2260022

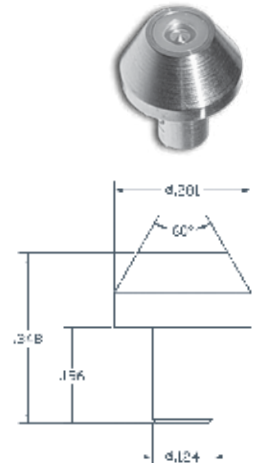

# PREMIUM DIAMOND ORIFICE - FOOD & SOFT MATERIALS

## DESCRIPTION

## PART No.

Water-Only, 60,000psi/4.100 bar

**Premium Diamond Orifice. Use for 60,000psi cutting food & soft materials like foam, rubber, and much more!**

0.005" / 0.12 mm	72113688
0.006" / 0.15 mm	72132350
0.007" / 0.17 mm	72113680
0.008" / 0.20 mm	72132358
0.009" / 0.23 mm	72136231
0.010" / 0.25 mm	72136249
0.011" / 0.28 mm	72136256
0.012" / 0.30 mm	72136264

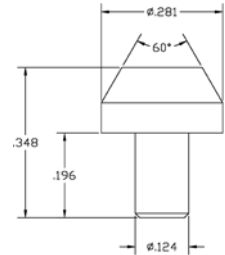

## WATER-ONLY ORIFICE STREAM COMPARISONS (60,000psi)

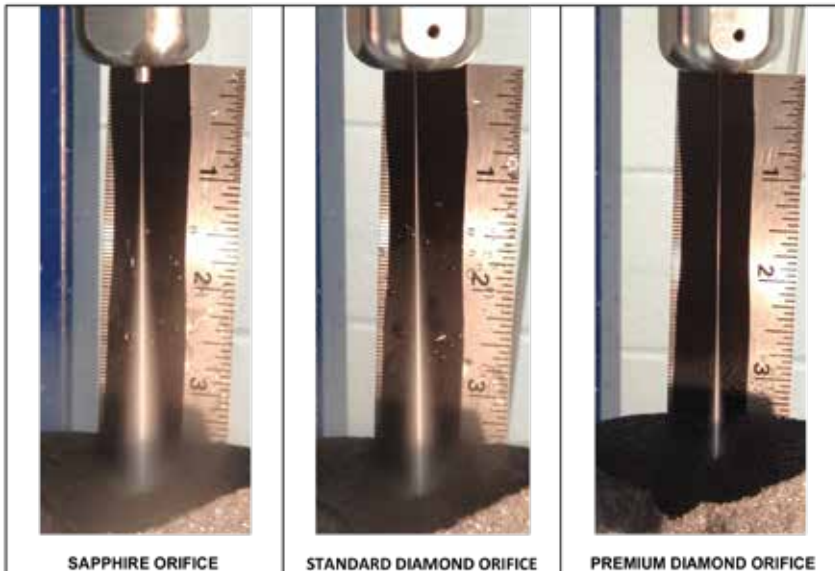

SAPPHIRE ORIFICE

STANDARD DIAMOND ORIFICE

PREMIUM DIAMOND ORIFICE

# WATER-ONLY ORIFICES/90,000PSI

## DESCRIPTION

Water-Only, 90,000psi/6.200 bar, Diamond

## PART No.

.004 (.102)	20481704
.005 (.127)	20481705
.006 (.152)	20481706
.007 (.178)	20481707
.008 (.203)	20481708
.009 (.229)	20481709
.010 (.254)	20481710
.011 (.279)	20481711
.012 (.305)	20481712
.013 (.330)	20481713
.014 (.356)	20481714
.015 (.381)	20481715
.016 (.406)	20481716
.017 (.412)	20481717
.018 (.457)	20481718
.019 (.483)	20481719
.020 (.508)	20481720
.021 (.533)	20481721
.022 (.559)	20481722

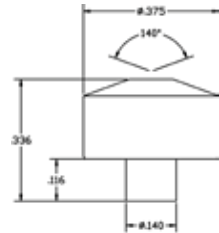

# FOCUSING TUBES

## DESCRIPTION

### PRO Series Indexed. 90,000psi/6.200 bar

The PRO Series features the superior HYPER-TUBE Index Design for longer, more uniform wear preventing "focusing tube blow-out"

	PART No.
0.030 x 3.0 / 0.76 mm x 76 mm	20477366
0.030 x 4.0 / 0.76 mm x 102 mm	20477382
0.033 x 4.0 / 0.84 mm x 102 mm	20490760
0.040 x 3.0 / 1.02 mm x 76 mm	20486133
0.040 x 4.0 / 1.02 mm x 102 mm	20486166
0.043 x 3.0 / 1.10 mm x 76 mm	20477386
0.043 x 4.0 / 1.10 mm x 102 mm	20477395
0.045 x 3.0 / 1.14 mm x 76 mm	20486151
0.045 x 4.0 / 1.14 mm x 102 mm	20486158
0.048 x 4.0 / 1.22 mm x 102 mm	20490768

HyperTube® Index Design



### ROCTEC® 100. 60,000psi/4.100 bar

0.021 x 3.13 / 0.53 mm x 79 mm	20451227
0.025 x 3.13 / 0.63 mm x 79 mm	20452309
0.030 x 3.13 / 0.76 mm x 79 mm	10126969
0.036 x 3.13 / 0.91 mm x 79 mm	80075252
0.039 x 3.13 / 0.99 mm x 79 mm	49833593
0.040 x 3.13 / 1.02 mm x 79 mm	49835390
0.043 x 3.13 / 1.10 mm x 79 mm	10126928
0.052 x 3.13 / 1.32 mm x 79 mm	05117528
0.058 x 3.13 / 1.47 mm x 79 mm	05051891
0.063 x 3.13 / 1.60 mm x 79 mm	10126936



# FOCUSING TUBES

## DESCRIPTION

**ROCTEC® 500. 60,000psi/4.100 bar**

0.021 x 2.0 / 0.53 mm x 50 mm
0.030 x 3.13 / 0.76 mm x 79 mm
0.036 x 3.13 / 0.91 mm x 79 mm
0.043 x 3.13 / 1.10 mm x 79 mm
0.093 x 3.13 / 2.36 mm x 79 mm

## PART No.

05097928
05097944
05116652
05097936
05130927



**Never shut down production for tank clean outs again.**

**The ATS 2200 and 4400 | Abrasive Removal Solution for Waterjet Cutting Systems is the perfect way to improve your waterjet operations.**



# SHAPE DELTA FOCUSING TUBES

## DELTA STANDARD - 60,000PSI

### PART No.

#### Delta Standard. 3.00" L, 60,000psi/4.100 bar

0.020 X 2.99 / 0.51 mm x 76 mm, 25D	1000005-20-299
0.030 X 2.99 / 0.76 mm x 76 mm, 25D	1000005-30-299
0.040 X 3.00 / 1.02 mm x 76 mm, 25D	1000005-40-300

#### Delta Standard. 3.125" L, 60,000psi/4.100 bar

0.015 X 3.13 / 0.38 mm x 79 mm, 25D	1000005-15-313
0.021 X 3.13 / 0.53 mm x 79 mm, 25D	1000005-21-313
0.030 X 3.13 / 0.76 mm x 79 mm, 25D	1000005-30-313
0.036 X 3.13 / 0.91 mm x 79 mm, 25D	1000005-36-313
0.039 X 3.13 / 0.99 mm x 79 mm, 25D	1000005-39-313
0.040 X 3.13 / 1.02 mm x 79 mm, 25D	1000005-40-313
0.043 X 3.13 / 1.10 mm x 79 mm, 25D	1000005-43-313



## DELTA NXT PREMIUM - 60,000PSI

#### Delta NXT Premium. 3.00" L, 60,000psi/4.100 bar

0.020 X 2.99 / 0.51 mm x 76 mm, 25D	1000006-20-299
0.030 X 2.99 / 0.76 mm x 76 mm, 25D	1000006-30-299
0.043 X 2.99 / 1.10 mm x 76 mm, 25D	1000006-43-299

#### Delta NXT Premium. 3.125" L, 60,000psi/4.100 bar

0.030 X 3.13 / 0.76 mm x 79 mm, 25D	1000006-30-313
0.036 X 3.13 / 0.91 mm x 79 mm, 25D	1000006-36-313
0.040 X 3.13 / 1.02 mm x 79 mm, 25D	1000006-40-313
0.063 X 3.13 / 1.60 mm x 79 mm, 25D	1000006-63-313



# SHAPE DELTA FOCUSING TUBES

## DELTA PREMIUM INDEXED - 90,000PSI

### PART No.

**Delta Premium Indexed. 3.00" L**  
**90,000psi/6.200 bar**

0.030 X 2.99 / 0.76 mm x 76 mm, 25D

1000007-30-299

0.040 X 2.99 / 1.02 mm x 76 mm, 25D

1000007-40-299

0.043 X 2.99 / 1.10 mm x 76 mm, 25D

1000007-43-299

**Delta NXT Premium Indexed. 4.00" L**  
**90,000psi/6.200 bar**

0.030 X 4.00 / 0.76 mm x 102 mm, 25D

1000007-30-400

0.040 X 4.00 / 1.02 mm x 102 mm, 25D

1000007-40-400

0.043 X 4.00 / 1.10 mm x 102 mm, 25D

1000007-43-400

0.048 X 4.00 / 1.22 mm x 102 mm, 25D

1000007-48-400



The KMT IDE<sup>®</sup> diamond cutting head cuts faster, extends focusing tube life and dramatically reduces downtime.

The IDE<sup>®</sup> cutting head has demonstrated 1,000+ cutting hours for most applications.

---

# **Pneumatic Valves (Water-Only) & Replacement Parts**

---



# PNEUMATIC VALVES / NO AND NC

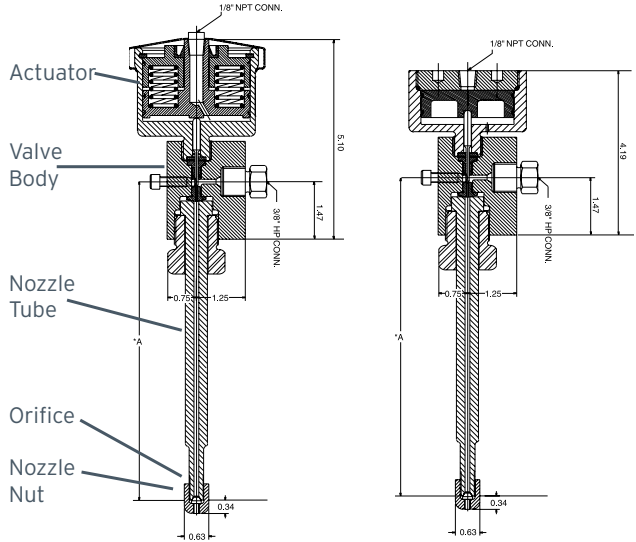







*Normally Closed*

*Normally Open*

Pure water cutting applications are among the most demanding of subcontracting jobs in the industry and the KMT AQUALINE® Water-Only valves are the industry's best!

# PNEUMATIC VALVE / ACTUATOR ASSEMBLIES

DESCRIPTION	PART No.	Image
<span style="color: blue;">■</span> UHP, 90,000psi/6.200 bar - N/C	20480359	
<span style="color: blue;">■</span> UHP, 90,000psi/6.200 bar - N/O 2-port Dump valve	20468634	
<span style="color: red;">■</span> HP, 60,000psi/4.100 bar - N/C	10138824	
<span style="color: red;">■</span> HP, 60,000psi/4.100 bar - N/C, IDE® Gland	20454354	
<span style="color: red;">■</span> HP, 60,000psi/4.100 bar - N/O	10184760	
<span style="color: red;">■</span> HP, 60,000psi/4.100 bar - N/O 2-Port Dump valve, Solenoid valve, Square body	05069703	
<span style="color: red;">■</span> HP, 60,000psi/4.100 bar - N/O 3-Port Dump valve, Round body	20427739	

# REPAIR KITS

## DESCRIPTION

## PART No.

**■** UHP Pneumatic Valve, N/C, 90,000psi/6.200 bar

20477521

Kit includes valve seat and stem, seal assembly, brass backup ring and o-rings required to service the valve and the actuator



**■** UHP Pneumatic Valve, N/O, 90,000psi/6.200 bar

20477518

Kit includes valve seat and stem, seal assembly, brass backup ring and o-rings required to service the valve and the actuator



**■** HP Pneumatic Valve, N/C, 60,000psi/4.100 bar

05116025

Kit includes valve seat and stem, seal assembly, backup ring & o-ring required to service the valve



**■** HP Pneumatic Valve, N/C, Cold Weather Seal Assembly, 60,000psi/4.100 bar

05146964

Kit includes valve stem and seat, CWS seal assembly, bronze backup ring and o-ring



**■** HP Pneumatic Valve, N/O, 60,000psi/4.100 bar

05116017

Kit includes valve seat and stem, seal assembly, backup ring & o-rings required to service the valve and the actuator



# TOOL KITS

## DESCRIPTION

## PART No.



### N/C Actuator Assembly

60,000/90,000psi - 4.100/6.200 bar  
Kit includes top and bottom protector tool, and snap ring pliers to service all HP and UHP, N/C pneumatic actuator assemblies

80077795



### Seal Tools, HP/UHP Pneumatic Valves

60,000/90,000psi - 4.100/6.200 bar  
Used to service all HP and UHP pneumatic valves. Kit includes a seal push, positioning and installation tool

20470475



## PNEUMATIC VALVE BODIES



### Stainless Steel

90,000psi/6.200 bar.  
For use on all KMT UHP pneumatic valves

20475871



### Dump Valve, Stainless Steel

90,000psi/6.200 bar.  
For use on all KMT UHP pneumatic dump valves

20468617



### 2-Port, (2) 0.38, (1) 0.56, Stainless Steel

60,000psi/4.100 bar.  
For use on all KMT 2-port HP pneumatic valves

10189181



### 3-Port, 0.38, Stainless Steel

60,000psi/4.100 bar.  
For use on all KMT 3-port HP pneumatic dump valves

20427648





# ACTUATORS

## DESCRIPTION

- UHP Actuator - N/C**  
 90,000psi/6.200 bar
- UHP Actuator - N/O**  
 90,000psi/6.200 bar
- HP Actuator - N/C**  
 60,000psi/4.100 bar
- HP Actuator - N/O**  
 60,000psi/4.100 bar
- Solenoid Valve - Air, 2 -3 Way, 2 Pos, 24V DC**  
 60,000/90,000psi - 4.100/6.200 bar
- Solenoid Valve - Air, 4-Way, 2 Pos, 24 VDC**  
 60,000psi/4.100 bar

## PART No.

20474154

20479022

10177855





10189553

49888035

05128715



# NOZZLE NUTS

DESCRIPTION	PART No.	Image
<span style="color: blue;">■</span> <b>0.56, UHP</b> 90,000psi/6.200 bar	20478993	
<span style="color: blue;">■</span> <b>0.75, UHP</b> 90,000psi/6.200 bar	20480993	
<span style="color: red;">■</span> <b>0.38, LH Thread</b> 60,000psi/4.100 bar	B2841	
<span style="color: red;">■</span> <b>0.56, LH Thread</b> 60,000psi/4.100 bar	B3393	



The KMT Waterjet Cut Calculator APP (available on Google Console & Apple Store) incorporates 25 materials, offers a wider range of substrate thicknesses, horsepower, orifice size, and abrasive rates.

The calculator shows the actual time differences cutting at 90,000psi vs. 60,000psi, calculating Speed/Capacity, Cost per Part/Job, and the Abrasive Consumption/Spinner

# VALVE GLANDS

## DESCRIPTION

## PART No.

- 0.56, Valve nut for Nozzle Tube, Stainless Steel**  
 60,000/90,000psi - 4.100/6.200 bar
- 0.75, Valve nut for Nozzle Tube, Stainless Steel**  
 60,000/90,000psi - 4.100/6.200 bar
- Compression Spring - 0.72 x 0.105 x 1.50, Stainless Steel**  
 60,000/90,000psi - 4.100/6.200 bar  
 For use on all NC KMT HP/UHP pneumatic actuators
- Adapter, UHP Dump Valve - 90,000psi/6.200 bar**
- Adapter, HP Water Valve**  
 60,000psi/4.100 bar  
 For use on all HP 3-port & quick release dump valves
- Adapter, Tube/Pipe, 0.25 x 0.13** 60,000psi/4.100bar  
 Used to connect air tube to solenoid valve on pneumatic valve/actuator assemblies. Replaces part 10077030
- Coupling Pipe, 0.13 x 0.13** 60,000psi/4.100 bar  
 Used to connect solenoid valve to actuator on pneumatic valve/actuator assemblies

BV701184



20454351



05054119

20451557



49830904



72149291



10102226



# NOZZLE TUBES

## DESCRIPTION

(ALL DIMENSIONS ARE DIAMETER" x LENGTH")

## PART No.

### 3/4", 90,000psi/6.200 bar, Valve Connection - IDE Connection (for use with Short Stop Filter)

0.75 x 3.50 / 1.9 x 8.89 cm, LH Thread

20487241

0.75 x 4.50 / 1.9 x 11.43 cm, LH Thread

20487249

0.75 x 5.75 / 1.9 x 14.60 cm, LH Thread

20487257

0.75 x 6.25 / 1.9 x 15.88 cm, LH Thread

20497106

0.75 x 9.75 / 1.9 x 24.77 cm, LH Thread

20487273



### 3/8", 60,000psi/4.100 bar, HP Connection - Nozzle Nut Connection (Extended Life)

0.38 x 2.56 / 0.97 x 6.50 cm

7219014145025

0.38 x 3.00 / 0.97 x 7.62 cm

7219014145030

0.38 x 4.00 / 0.97 x 10.16 cm

7219014145040

0.38 x 8.00 / 0.97 x 20.32 cm

7219014145080

0.38 x 9.00 / 0.97 x 22.86 cm

7219014145090

0.38 x 10.0 / 0.97 x 25.4 cm

7219014145100

0.38 x 11.0 / 0.97 x 27.94 cm

7219014145110

0.38 x 12.0 / 0.97 x 30.48 cm

7219014145120



# NOZZLE TUBES

## DESCRIPTION

(ALL DIMENSIONS ARE DIAMETER" x LENGTH")

## PART No.

**3/8", 60,000psi/4.100 bar, Valve Connection - HP Connection**

0.38 x 4.0 / 0.97 x 10.16 cm	10138584
0.38 x 5.0 / 0.97 x 12.70 cm	10138592
0.38 x 6.0 / 0.97 x 15.24 cm	10138600
0.38 x 7.0 / 0.97 x 17.78 cm	10138618
0.38 x 8.0 / 0.97 x 20.32 cm	10138634
0.38 x 9.0 / 0.97 x 22.86 cm	10138642
0.38 x 10.0 / 0.97 x 25.40 cm	10138659



**3/8", 60,000psi/4.100 bar, Valve Connection - Nozzle Nut Connection**

0.38 x 3.0 / 0.97 x 10.16 cm	10181113
0.38 x 4.0 / 0.97 x 10.16 cm	10138402
0.38 x 5.0 / 0.97 x 12.70 cm	10138410
0.38 x 6.0 / 0.97 x 15.24 cm	10138428
0.38 x 7.0 / 0.97 x 17.78 cm	10138436
0.38 x 8.0 / 0.97 x 20.32 cm	10138444
0.38 x 9.0 / 0.97 x 22.86 cm	10138451
0.38 x 10.0 / 0.97 x 25.40 cm	10138469
0.38 x 11.0 / 0.97 x 27.94 cm	05136031
0.38 x 12.0 / 0.97 x 30.48 cm	05013735



**3/8", 60,000psi/4.100 bar, HP Connection - Nozzle Nut Connection**

0.38 x 3.0 / 0.97 x 7.62 cm	A22593
0.38 x 4.0 / 0.97 x 10.16 cm	A22594
0.38 x 5.0 / 0.97 x 12.70 cm	A22595
0.38 x 6.0 / 0.97 x 15.24 cm	A22596
0.38 x 8.0 / 0.97 x 20.32 cm	A2259800
0.38 x 10.0 / 0.97 x 25.40 cm	A225910
0.38 x 11.0 / 0.97 x 27.94 cm	A225911
0.38 x 12.0 / 0.97 x 30.48 cm	A225912



# NOZZLE TUBES

## DESCRIPTION

(ALL DIMENSIONS ARE DIAMETER" X LENGTH")

## PART No.

### 9/16", 60,000psi/4.100 bar, Valve Connection - HP Connection

0.56 x 4.0 / 1.42 x 10.16 cm

10138667

0.56 x 5.0 / 1.42 x 12.70 cm

10138675

0.56 x 6.0 / 1.42 x 15.24 cm

10138683

0.56 x 7.0 / 1.42 x 17.78 cm

10138691

0.56 x 8.0 / 1.42 x 20.32 cm

10138709

0.56 x 9.0 / 1.42 x 22.86 cm

10138717

0.56 x 10.0 / 1.42 x 25.40 cm

10138725

0.56 x 11.0 / 1.42 x 27.94 cm

80074446



### 9/16", 60,000psi/4.100 bar, Valve Connection - Nozzle Nut Connection

0.56 x 4.0 / 1.42 x 10.16 cm

10138485

0.56 x 5.0 / 1.42 x 12.70 cm

10138493

0.56 x 6.0 / 1.42 x 15.24 cm

10138501

0.56 x 7.0 / 1.42 x 17.78 cm

10138519

0.56 x 8.0 / 1.42 x 20.32 cm

10138527

0.56 x 9.0 / 1.42 x 22.86 cm

10138535

0.56 x 10.0 / 1.42 x 25.40 cm

10181105

0.56 x 12.0 / 1.42 x 30.48 cm

10193100



### 3/4", 60,000psi/4.100 bar, Valve Connection - IDE Connection

0.75 x 3.75 / 1.91 x 9.53 cm, LH Thread

20489074

0.75 x 4.75 / 1.91 x 12.07 cm, LH Thread

20489092

0.75 x 5.75 / 1.91 x 14.60 cm, LH Thread

20455329

0.75 x 7.75 / 1.91 x 19.69 cm, LH Thread

20480977

0.75 x 8.75 / 1.91 x 22.23 cm, LH Thread

72101354

0.75 x 9.75 / 1.91 x 24.77 cm, LH Thread

20464647



## HIGH PRESSURE FITTINGS & TUBING

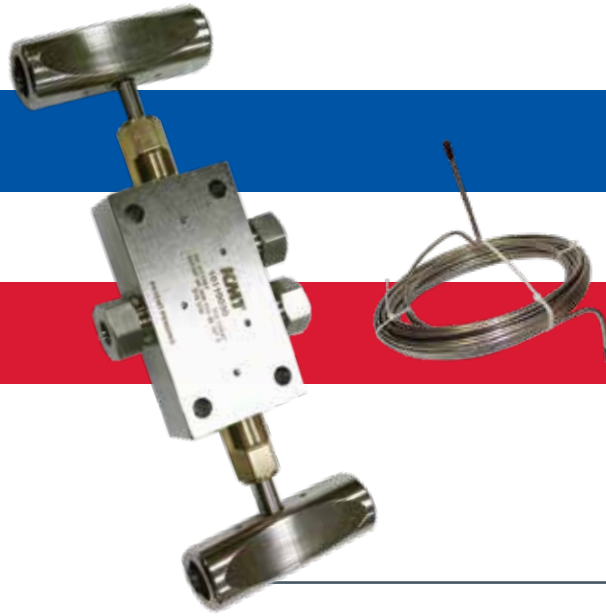

# High Pressure Fittings & Tubing

# ULTRA-HIGH PRESSURE TUBING

## DESCRIPTION

## PART No.

**Stainless Steel Tubing - 90,000psi/6.200 bar  
Coned & Threaded - Up to 4' Lengths**

0.25 x 0.083 x 3.02", HP160	20489761
0.25 x 0.083 x 4.0", HP160	20487975
0.25 x 0.083 x 7.625", HP160	72104402
0.38 x 0.125 x 4.0", HP160	20478649
0.38 x 0.125 x 4.81", HP160	20468830
0.38 x 0.125 x 48.0", HP160	20489107
0.56 x 0.188 x 4.25", HP160	20493999
0.56 x 0.188 x 6.38", HP160	72103733
0.56 x 0.188 x 8.93", HP160	72103386
0.56 x 0.188 x 14.49", HP160	72103361
0.56 x 0.188 x 17.22", HP160	72103379
0.56 x 0.188 x 36.0", HP160	72108319

**Coned & Threaded - 20' Length,  
90,000psi/6.200 bar**

0.25 x 0.083 x 240.0", HP160	20478751
0.38 x 0.083 x 240.0", HP160	20489115
0.56 x 0.083 x 240.0", HP160	72103535

**Ultra-high Pressure Tubes sold by the inch  
90,000psi/6.200 bar**

0.25	20455383
0.38	20455386
0.56	20455389





# HIGH PRESSURE TUBING

## DESCRIPTION

## PART No.

**Stainless Steel Tubing - 60,000psi/4.100 bar**  
**Coned & Threaded - Up to 8' Lengths**

0.25 x 0.083 x 4.0", 316	10105880
0.25 x 0.083 x 6.0", 316	10103018
0.25 x 0.083 x 8.0", 316	80070519
0.38 x 0.125 x 3.0", 316	10094704
0.38 x 0.125 x 4.0", 316	10105443
0.38 x 0.125 x 5.0", 316	10090280
0.56 x 0.188 x 4.0", 316	10069326
0.56 x 0.188 x 4.97", 316	05112057

**Coned & Threaded - 20' Length**  
**60,000psi/4.100 bar**

0.25 x 0.083 x 240.0", 316	10094191
0.38 x 0.083 x 240.0", 316	10094183
0.56 x 0.083 x 240.0", 316	10094175

**HP Tubes. Sold by the inch**  
**60,000psi/4.100 bar**

0.25	10064376
0.38	10064665
0.56	10061190



# HP TUBING - ACCESSORIES

## DESCRIPTION

## PART No.

**Hose - Ferrule - 60,000psi/4.100 bar**

0.25 x 0.265 x 0.718, Brass

20422970

0.38 x 0.265 x 0.718, Brass

10083897

0.56 x 0.265 x 0.718, Brass

05131347

**Conduit - Extra Flexible - 60,000psi/4.100 bar  
Sold by the inch**

0.25, Stainless steel

20422988

0.38, Stainless steel

10186153

0.56, Stainless steel

05086905

**HP & UHP stainless steel bent tubing is intensifier model specific. Please contact your local KMT representative for ordering assistance. 60,000/90,000psi-4.100/6.200 bar**

**HP & UHP stainless steel coils are robot specific. Please contact your local KMT representative for ordering assistance. 60,000/90,000psi-4.100/6.200 bar**



# HP FITTINGS

## DESCRIPTION

## PART No.

**UHP Stainless Steel Coupling Assembly,  
 90,000psi/6.200 bar**

0.25 x 0.25

20477023

0.38 x 0.25

20477738

0.38 x 0.38

20477660

0.56 x 0.25

20477730

0.56 x 0.38

20477709

0.56 x 0.56

20477685



**HP Stainless Steel Coupling Assembly,  
 60,000psi/4.100 bar**

0.25 x 0.25

10079028

0.38 x 0.25

10079614

0.38 x 0.38

10078905

0.56 x 0.25

10078145

0.56 x 0.38

10079531

0.56 x 0.56

10078640



**UHP Stainless Steel Elbow Assembly,  
 90,000psi/6.200 bar**

0.25

20455821

0.38

20455809

0.56

20455377



**HP Stainless Steel Elbow Assembly,  
 60,000psi/4.100 bar**

0.25

10079051

0.38

10078780

0.56

10078525



# HP FITTINGS

DESCRIPTION	PART No.
<b>UHP Stainless Steel Tee Assembly, 90,000psi/6.200 bar</b> 0.25 0.38 0.56	20455824
	20455812
	20455374
<b>HP Stainless Steel Tee Assembly, 60,000psi/4.100 bar</b> 0.25 0.38 0.56	10079481
	10078590
	10079465
<b>UHP Stainless Steel Cross Assembly, 90,000psi/6.200 bar</b> 0.25 0.38 0.56	20452971
	20452968
	20453115
<b>HP Stainless Steel Cross Assembly, 60,000psi/4.100 bar</b> 0.25 0.38 0.56	10097228
	10078038
	10079168



# HP FITTINGS

## DESCRIPTION

## PART No.

**UHP Stainless Steel Bushing Assembly,  
 90,000psi/6.200 bar**

0.38 F x 0.25 M	72133175
0.38 M x 0.25 F	72133224
0.56 F x 0.25 M	72133183
0.56 M x 0.25 F	72133232
0.56 F x 0.38 M	72133209
0.56 M x 0.38 F	72133250

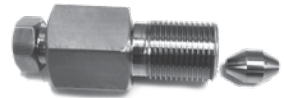

**HP Stainless Steel Bushing Assembly,  
 60,000psi/4.100 bar**

0.38 M x 0.25 F	10079432
0.38 F x 0.25 M	10079473
0.56 M x 0.25 F	10079580
0.56 F x 0.25 M	10079424
0.56 M x 0.38 F	10079457
0.56 F x 0.38 M	10079655



**UHP Stainless Steel Collar  
 90,000psi/6.200 bar**

0.25	20452959
0.38	20452965
0.56	20453124



**HP Stainless Steel Collar  
 60,000psi/4.100 bar**

0.25	10078426
0.38	10078715
0.56	10079119



# HP FITTINGS

DESCRIPTION	PART No.
<b>UHP Stainless Steel Gland</b> <b>90,000psi/6.200 bar</b> 0.25 0.38 0.56	20452962
	20452956
	20453121
<b>HP Stainless Steel Gland</b> <b>60,000psi/4.100 bar</b> 0.25 Anti-Vibration, 0.25 0.38 Anti-Vibration, 0.38 0.56 Anti-Vibration, 0.56	10078459
	10078699
	10078129
	10078913
	10078608
	10093573
<b>UHP Stainless Steel Adapter Cone,</b> <b>90,000psi/6.200 bar</b> 0.25 0.38 0.56	72133266
	72122072
	72133349
<b>HP Stainless Steel Adapter Cone,</b> <b>60,000psi/4.100 bar</b> 0.25 0.38 0.56	10116333
	10078509
	10079291



# HP FITTINGS

DESCRIPTION	PART No.	
<span style="color: blue;">■</span> UHP Stainless Steel Plug, 90,000psi/6.200 bar	0.25	20453130
	0.38	20453136
	0.56	20453127
<span style="color: red;">■</span> HP Stainless Steel Plug, 60,000psi/4.100 bar	0.25	10078244
	0.38	10079523
	0.56	10078772
<span style="color: blue;">■</span> UHP Stainless Steel Hand Valve, Straight, 90,000psi/6.200 bar	0.25	20467981
	0.38	20468568
	0.56	20468014
<span style="color: red;">■</span> HP Stainless Steel Hand Valve, Straight, 60,000psi/4.100 bar	0.25	10079259
	0.38	10078863
	0.56	10078889



# HP FITTINGS

## DESCRIPTION

## PART No.

■ UHP Stainless Steel Hand Valve, 90 degree,  
90,000psi/6.200 bar

0.25

20468610

0.38

20468593

0.56

20477836



■ HP Stainless Steel Hand Valve, 90 degree,  
60,000psi/4.100 bar

0.25

10079002

0.38

10078749

0.56

10079275



■ HP Stainless Steel Valve Assembly, 3-Way,  
1 Press, 0.38, 2 Stem  
60,000psi/4.100 bar

10119030





# CHECK VALVE ASSEMBLIES

DESCRIPTION	PART No.	
<span style="color: blue;">■</span> Poppet Check Valve PRO Assembly 90,000psi/6.200 bar	0.38	20477619
	0.56	20455911
	Repair Kit	72135447
<span style="color: red;">■</span> Poppet Check Valve Assembly 60,000psi/4.100 bar	0.25	80073885
	0.38	05149182
	0.56	05113972



Cutting Heads    Diamond Orifices    Fittings & Tubing    Valve Repair Kits

**KMT Genuine Parts are manufactured in the USA to the exact standards as the original parts found on new KMT pumps. The use of inferior imitation parts will void warranty coverage, compromises safety & may result in reduced component lifetime.**

**BEWARE of websites that use the KMT logo to imply their parts are manufactured by KMT, but are not KMT Genuine Parts.**

# INLINE WATER FILTERS

## DESCRIPTION

### Filter Element UHP Water Filter Assembly

90,000psi/6.200 bar  
Sintered Cup, 20 Micron.  
For use with UHP Filter Assembly 20475916 &  
20475944

### Filter Element UHP Water Filter Assembly

90,000psi/6.200 bar  
Sintered Cup, 20 Micron.  
For use with UHP Filter Assembly 20481026 &  
20480940

### Filter Element - HP Water Filter Assembly

60,000psi/4.100 bar  
0.25, Sintered Cup, 20 Micron.  
For use with HP Filter Assembly 05114137

### Filter Element - HP Water Filter Assembly

60,000psi/4.100 bar  
.38, Sintered Cup, 20 Micron.  
For use with HP Filter Assembly 49863715

### Filter Element - HP Water Filter Assembly

60,000psi/4.100 bar  
0.56, Sintered Cup, 20 Micron.  
For use with HP Filter Assembly BF103473  
Utilizes 10074599 o-ring, sold separately.

## PART No.

20453553



20456913



05110531



SKJA266



AF503473



# HP WATER FILTER ASSEMBLIES

DESCRIPTION	PART No.	
<p><b>UHP Water Filter Assembly - Inline</b></p> <p>90,000psi/6.200 bar Small</p>	0.25, Stainless Steel	20481026
	0.38, Stainless Steel	20480940
	<hr/>	
<p><b>UHP Water Filter Assembly - Inline</b></p> <p>90,000psi/6.200 bar Large</p>	0.38, Stainless Steel	20475916
	0.56, Stainless Steel	20475944
	<hr/>	
<p><b>HP Water Filter Assembly - Inline</b></p> <p>60,000psi/4.100 bar 0.25, 20 Micron, Stainless Steel</p>	05114137	
<p><b>HP Water Filter Assembly - Inline</b></p> <p>60,000psi/4.100 bar 0.38, 20 Micron, Stainless Steel</p>	CJ200988	
<p><b>HP Water Filter Assembly - Inline</b></p> <p>60,000psi/4.100 bar 0.56, 20 Micron, Stainless Steel</p>	BF103473	
<p><b>Bayonet Nipple - HP Water Filter</b></p> <p>60,000psi/4.100 bar 0.38 - For use in HP Filter Assembly 49863715</p>	SKJA287	



# SWIVEL JOINTS

DESCRIPTION	PART No.	
<span style="color: blue;">■</span> <b>UHP, Straight, 0.25, F/F Connections</b> 90,000psi/6.200 bar	20477623	
<span style="color: blue;">■</span> <b>UHP, Straight, 0.25 F/M Connections</b> 90,000psi/6.200 bar	20490851	
<span style="color: blue;">■</span> <b>UHP, 90°, 0.25 F/M Connections</b> 90,000psi/6.200 bar	72108129	
<span style="color: blue;">■</span> <b>UHP, 90°, 0.25 F/F Connections</b> 90,000psi/6.200 bar	20491098	
<span style="color: red;">■</span> <b>HP, 90°, 0.25 F/F Connections</b> 60,000psi/4.100 bar	CJ218188	
<span style="color: red;">■</span> <b>HP, 90°, 0.25 M/F Connections</b> 60,000psi/4.100 bar	CJ201288	
<span style="color: red;">■</span> <b>HP, 90°, 0.38 M/F Connections</b> 60,000psi/4.100 bar	10134682	

## SWIVEL JOINTS - CAP ASSEMBLIES

<span style="color: red;">■</span> <b>Cap Assembly, 0.25/0.38, M/F</b> 60,000psi/4.100 bar	BJ701288	
<span style="color: red;">■</span> <b>Cap Assembly, 0.25, F/F</b> 60,000psi/4.100 bar	CJ418088	

# SWIVEL JOINTS - STRAIGHT BODIES

## DESCRIPTION

- **UHP Body - Straight, 0.25 Connections**  
90,000psi/6.200 bar
- **HP Body - Straight, 0.25 Connections**  
60,000psi/4.100 bar
- **HP Body - Straight, 0.38 Connections**  
60,000psi/4.100 bar

## PART No.

- 20486976
- CJ211388
- 10134716\*



## SWIVEL JOINTS - STRAIGHTS

- **UHP Spindle - 0.25 F**  
90,000psi/6.200 bar
- **UHP Spindle - 0.25 M**  
90,000psi/6.200 bar
- **HP Spindle - 0.25 F**  
60,000psi/4.100 bar
- **HP Spindle - 0.25 M**  
60,000psi/4.100 bar
- **HP Spindle - 0.38 M**  
60,000psi/4.100 bar

- 20486952
- 20490843
- CJ318088
- CJ201288
- 49899602



# SWIVEL JOINTS - STRAIGHTS

## DESCRIPTION

- **UHP, Straight, 0.25 F/F Connections**  
90,000psi/6.200 bar
- **UHP, Straight, 0.25 F/M Connections**  
90,000psi/6.200 bar
- **HP, Straight, 0.25 F/F Connections**  
60,000psi/4.100 bar
- **HP, Straight, 0.25 M/F Connections**  
60,000psi/4.100 bar
- **HP, Straight, 0.38 M/F Connections**  
60,000psi/4.100 bar

## PART No.

- 20477623
- 20490851
- CJ218088
- CJ211388
- 10134708



## 90 DEGREE BODIES

### DESCRIPTION

- **UHP Body - 90°, 0.25 Connections**  
90,000psi/6.200 bar
- **HP Body - 90°, 0.56 x 0.25 M/F Connections**  
60,000psi/4.100 bar
- **HP Body - 90° 0.38 x 0.38 M/F Connections**  
60,000psi/4.100 bar

### PART No.

- 20490859
- DJ301288
- 10134690



## BUSHINGS

- **Bushing, 0.25/0.38 Connection**  
60,000psi/4.100 bar

CJ401288



# SEAL ASSEMBLIES

## DESCRIPTION



**Thrust Bearing , 0.25 Connections**  
 90,000psi/6.200 bar



**Thrust Bearing 0.25/0.38 Connection**  
 60,000psi/4.100 bar

## PART No.

20475956

10084713



# SEAL ASSEMBLIES

## DESCRIPTION



**Seal Assembly, 0.25 Connections**  
 90,000psi/6.200 bar



**Seal Assembly, 0.25/0.38 Connection**  
 60,000psi/4.100 bar



**Clamp Collar, 0.25, F/F Connection**  
 60,000psi/4.100 bar



**Thrust Washer, 0.25/0.38 Connections**  
 60,000psi/4.100 bar

## PART No.

20487002

BJ201388

10154680

10094647



# REPAIR & TOOL KITS

## DESCRIPTION

### Repair Kit - UHP Swivel Joint Assembly, 0.25/0.38 Connections

90,000psi/6.200 bar

Kit includes seal assembly, thrust bearing and washer, and setscrew required to service all UHP swivel joint assemblies

## PART No.

72129713



### Tool Kit - UHP Swivel Joint Assembly

90,000psi/6.200 bar

Kit includes maintenance tools and lubricants required to repair any UHP swivel joint assembly

20488720



### Repair Kit - HP Swivel Joint Assembly, 0.25/0.38 Connections

60,000psi/4.100 bar

Kit includes seal assembly, thrust bearing and washer, and setscrew required to service all HP swivel joint assemblies

05116009





# CONING & THREADING TOOL KITS

## DESCRIPTION



### Tool Kit - Hand Threading & Power Coning Tools

60,000/90,000psi-4.100/6.200 bar

Kit includes 0.25, 0.38 and 0.56 power coning & hand threading tool



### Tool Kit - Power Coning/Threading Tools

60,000/90,000psi-4.100/6.200 bar

Kit includes 0.25, 0.38 and 0.56 power coning & power threading tool

## PART No.

20454198



20454201



The KMT Waterjet Genuine Service team offers 360° Assured Preventive Programs to keep your KMT pump operating at peak performance so you can focus on your business.



# THREADING TOOL ASSEMBLIES

## DESCRIPTION

Tool Assemblies include 4 oz. Coning Lubricant

## PART No.

	<b>Hand Threading Tool Assemblies, 60,000/90,000psi-4.100/6.200 bar</b>	
	0.25	05108865
	0.38	05108857
	0.56	05108840
	<b>Power Threading Tool Assemblies, 60,000/90,000psi-4.100/6.200 bar</b>	
	0.25	05122742
	0.38	05120258



## CONING & THREADING

	<b>Blade, 60,000/90,000psi-4.100/6.200 bar</b>	
	0.25, Hand or Power, Coning	05108808
	0.38, Hand or Power, Coning	05108824
	0.56, Hand or Power, Coning	05108816
	<b>Retainer, 60,000/90,000psi-4.100/6.200 bar</b>	
	0.25, Hand or Power, Bronze, Threading	05108741
	0.38, Hand or Power, Bronze, Threading	05108758
	0.56, Hand or Power, Bronze, Threading	05108766
	<b>Retainer, 60,000/90,000psi-4.100/6.200 bar</b>	
	0.25, Power, Bronze, Coning	05109814
	0.38, Power, Bronze, Coning	05109822
	0.56, Power, Bronze, Coning	05109830
	<b>Tube Vise, 60,000/90,000psi-4.100/6.200 bar</b>	
	0.25	05108782
	0.38	05108790
	0.56	05108774



# CONING & THREADING

## DESCRIPTION

## PART No.

■ ■	<b>Threading Die, 60,000/90,000psi-4.100/6.200 bar</b>
	1/4-28 LH, 0.25, Hand or Power
	3/8-24 LH, 0.38, Hand or Power
	9/16-18 LH, 0.56, Hand or Power

05108899

05108915

10078301



■ ■	<b>Collet, 60,000/90,000psi-4.100/6.200 bar</b>
	0.25, Hand Coning, Stainless Steel
	0.38, Hand Coning, Stainless Steel
	0.56, Hand Coning, Stainless Steel

05108972

05108964

20439964



**Over 50% of the waterjet operating cost is purchasing abrasive garnet.**

**Powering up to 90,000psi will lower your abrasive usage by 50%, increase your cutting efficiency by over 50%, and reduce electrical**



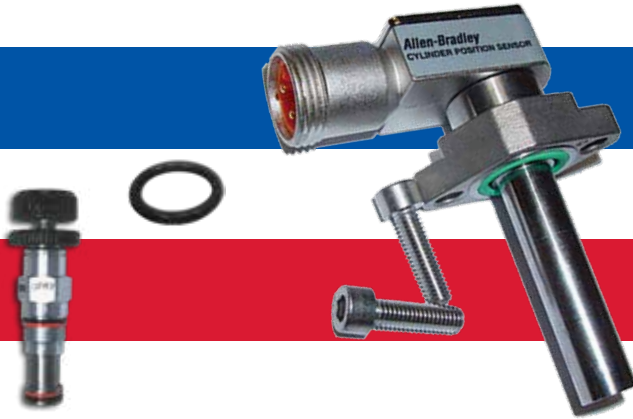

---

# Miscellaneous Parts & Supplies

---

# LP WATER FILTER COMPONENTS

## DESCRIPTION

## PART No.

■	Filter Element, LP Water, 10.0 long, polypropylene	10106722	
	60,000psi/4.100 bar		
	10 micron		
	40 micron	10100782	
■ ■	Filter Element, LP Water 10 micron, 20.0 long, polypropylene, 60,000/90,000psi-4.100/6.200 bar	72125264	
	Used on all SL-VI (PRO) units		
■ ■	Filter Element, LP Water 10 micron, 20.0 long, polypropylene, 60,000/90,000psi-4.100/6.200 bar	49834716	
	Used on all SL-V, PRO-I and PRO-2 units		
■ ■	Filter Housing Assembly, LP Water 0.75 FNPT connection, stainless steel, manual relief valve, 60,000/90,000psi-4.100/6.200 bar	72155272	
	Uses Part Number 72125264 Filter Element		
■ ■	Filter Housing Assembly - LP Water, 0.75 FNPT connections, stainless steel, manual relief valve, 60,000/90,000psi-4.100/6.200 bar	72118339	
	Uses Part Number 49834716 Filter Element		
	Replaces Part #05038690		
■ ■	Filter Strainer, 50 NPTF, 40 Mesh, polypropylene 60,000/90,000psi-4.100/6.200 bar	20412815	

## HYDRAULIC OIL FILTER COMPONENTS

■ ■	Hydraulic, 6 micron, 4.0 long, spin on, 60,000/90,000psi-4.100/6.200 bar	05049689	
	For 15 to 60 horsepower units		
■ ■	Hydraulic, 10 micron, 9.40 long, spin on, 60,000/90,000psi-4.100/6.200 bar	05104187	
	For 75 to 200 horsepower units		

# O-RINGS FOR SEALING HEADS

## DESCRIPTION

## PART No.

**O-Ring - 131, 1.69 x 1.88 x 0.09, Buna-N, D-70**

10146082

90,000psi/6.200 bar

Used on all PRO-I units,  
Used on sealing head 20480113



**O-Ring, Metric, 3MM x 1XX, Buna-N, D-70**

05049853

60,000psi/4.100 bar

Used on SL-IV units  
Used on sealing head 05116769



# O-RINGS FOR PNEUMATIC VALVES

**O-Ring - 035, 2.25 x 2.38 x 0.06, Viton, D-75**

10074565

Used on all 60,000/90,000psi-4.100/6.200 bar  
N/O pneumatic actuator assemblies



**O-Ring - 143, 2.44 x 2.63 x 0.09, Viton, D-75**

10074714

Used on all 60,000/90,000psi-4.100/6.200 bar  
N/O pneumatic actuator assemblies



**O-Ring - 038, 2.63 x 2.75 x 0.06, Viton, D-70**

10177806

Used on all 60,000/90,000psi-4.100/6.200 bar  
N/C pneumatic actuator assemblies



**O-Ring - 044, 0.08 x 0.20 x 0.06, Viton, D-75**

49895584

Used on all 60,000/90,000psi-4.100/6.200 bar  
N/C pneumatic valve assemblies



# O-RINGS FOR TOPWORKS

## DESCRIPTION

## PART No.

- O-Ring - 344, 3.88 x 4.25 x 0.19, Buna-N, D-90A**  
**90,000psi/6.200 bar**  
 Used on all PRO-III units  
 Used on hydraulic cylinder head
- O-Ring - 115, 0.69 x 0.88 x 0.09, Buna-N, D-70**  
**90,000psi/6.200 bar**  
 Used on the proximity switch of all PRO units
- O-Ring - 218, 1.25 x 1.50 x 0.13, Polyurethane, D-70, 60,000/90,000psi-4.100/6.200 bar**  
 Used on all hydraulic piston assemblies
- O-Ring - 252, 5.25 x 0.5 x 0.13, Viton, D-75, 60,000/90,000psi-4.100/6.200 bar**  
 Used on all SL-V and SL-VI (PRO) units with a 75 (PRO: 60) to 200 horsepower rating  
 Used on hydraulic cylinder head
- O-Ring - 132, 1.75 x 1.94 x 0.09, Buna-N, D-70**  
**60,000psi/4.100 bar**  
 Used on all SL-V, SL-VI and NL-I units  
 O-Ring for LP water inlet
- O-Ring - 214, 1.0 x 1.25 x 0.13, Buna-N, D-70**  
**60,000psi/4.100 bar**  
 Used on all OEM 50 units and all SL-V and NL-I units with a 15 to 60 horsepower rating  
 Used on intensifier support

72176756



05144191



05087713



10074771



10074920



10074409



# O-RINGS FOR TOPWORKS

## DESCRIPTION



**O-Ring - 240, 3.75 x 4.0 x 0.13,  
Buna-N, D-70. 60,000psi/4.100 bar**

Used on all SL-IV, SL-V, SL-VI and NL-I units with a 15  
to 60 horsepower rating  
Used on hydraulic cylinder head



**O-Ring - 129, 1.56 x 1.75 x 0.09,  
Buna-N, D-70. 60,000psi/4.100 bar**

Used on all SL-IV units  
O-Ring for LP water inlet

## PART No.

10075000



10074904



Since 1971, we are proud to be the pioneers of waterjet  
technology, located in the Heart of America, Baxter Springs, KS.

We specialize in the design & manufacturing of waterjet  
cutting pumps & technology and are dedicated to helping  
our customers grow & accelerate their businesses.





# O-RINGS FOR CUTTING HEADS

## DESCRIPTION

## PART No.

 **O-Ring - 012, 0.38 x 0.50 x 0.06, Buna-N, D-70. 90,000psi/6.200 bar**  
 Used on wear insert for AUTOLINE PRO cutting head assemblies

05077078



 **O-Ring - 011, 0.31 x 0.44 x 0.06, Aflas, D-70**  
 AUTOLINE II & AUTOLINE PRO cutting head assemblies, **60,000/90,000psi-4.100/6.200 bar pumps**. Used in wear insert 20453064

20445476



 **O-Ring - 018, 0.75 x 0.88, Polyurethane, D-70. 90,000psi/6.200 bar**  
 AUTOLINE PRO cutting head assemblies  
 Used in cap 20480732

05142286



 **O-Ring, 0.69 x 0.81 x 0.06**  
 AUTOLINE II & AUTOLINE PRO cutting head assemblies, **60,000/90,000psi-4.100/6.200 bar pumps**  
 Used in nozzle body 20480715 & 20453958

05138821



 **O-Ring - 013, 0.44 x 0.56 x 0.06, Buna-N, D-70**  
 Used on Abrasive Inlet Adapter  
 Used on IDE II & IDE PRO cutting heads  
**60,000/90,000psi-4.100/6.200 bar pumps**

10074870



 **O-Ring - 012, 0.38 x 0.50 x 0.06, Polyurethane, D-70. 60,000psi/4.100 bar**  
 Used on AUTOLINE I & AUTOLINE II cutting head assemblies  
 Used in cap 20453952 & 05076971  
**60,000psi/4.100pumps**

05081518



 **O-Ring - 016, 0.63 x 0.75 x 0.06, Polyurethane, D-70. 60,000psi/4.100 bar**  
 Used on AUTOLINE I cutting head assemblies  
 Used in nozzle body 05073820

05092887



 **O-Ring - 014, 0.50 x 0.63 x 0.06, Polyurethane, D-70. 60,000psi/4.100 bar**  
 Used on AUTOLINE I cutting head assemblies

05104930



# O-RINGS FOR INLINE FILTERS

## DESCRIPTION

## PART No.

- O-Ring - 012, 0.38 x 0.50 x 0.06, Viton, D-75. 60,000psi/4.100 bar**  
Used in 49893555 Filter Assembly

10074599



## BOOSTER PUMPS

### Booster Pump, Stainless Steel, CW ROT

200psi/14 bar, 1.33 gpm. 90,000psi/6.200 bar  
Used on PRO units with a 60 horsepower rating

20481206

115psi/8 bar, 3.13 gpm  
Used on all SL-V 60,000psi and PRO 90,000psi units  
with a 75 to 125 horsepower rating

49836778

200psi/14 bar, 1.33 gpm  
Used on all SL-V 60,000psi units with a 15 to  
60 horsepower rating

49887094

200psi/14 bar, 1.33 gpm  
Used on all SL-V 60,000psi units with a 15 to  
60 horsepower rating and temperature probe

05071659



## HOSES

### Polyurethane Tubing - 0.38, Clear

60,000/90,000psi-4.100/6.200 bar

49885361

### Push-on Hose - 0.50, 290psi/20 bar, Blue

60,000/90,000psi-4.100/6.200 bar

20421272

### PVC Tubing - 0.50 x 0.748, Reinforced, Static-free

60,000/90,000psi-4.100/6.200 bar

05076963

### Flexible Tubing - 0.50, Nylon

60,000/90,000psi-4.100/6.200 bar

05044532



All dimensions in inch unless specified otherwise.

Order online 24/7: [kmtgenuineparts.com](http://kmtgenuineparts.com)

# GAUGES

## DESCRIPTION

**Pressure Gauge - 0-15,000psi/0-10.300 bar**

0.38 HP, Flush Mount, 6" Face, Glycerin filled  
 For use on 90,000psi/6.200 bar pumps  
 Requires 20464745 Adapter

**Pressure Gauge - 0-20psi/0-14 bar. Used on 60,000/90,000psi-4.100/6.200 bar pumps**

0.25 NPT, back mount, Stainless Steel

**Pressure Gauge - 0-5,000psi/0-350 bar**

0.25 bottom mount. For use on 60,000psi/4.100 bar pumps  
 For 0.88 plungers, SL-IV and SL-V 60,000psi/4.100 bar pumps

**Pressure Gauge -0-100,000psi/ 0-6.900 bar**

0.25 HP, 4.25" Face, bottom mount. For use on 60,000psi/4.100 bar pumps  
 For use on 60,000psi/4.100 bar pumps

**Pressure Gauge - 0-100,000psi/ 0-6.900 bar, 60,000psi/4.100 bar pumps**

0.25 HP, Bottom Mount. 6" Face, Glycerin filled  
 For use on 60,000psi/4.100 bar pumps

## PART No.

20467883



05139506



05045497



20443831



05125836

# ELECTRICAL COMPONENTS

DESCRIPTION	PART No.	
<p> <b>Solenoid Valve - 24V DC</b> 60,000psi/4.100 bar .13, 2-3 Way, 2 Pos</p>	49888035	
<p> <b>Output Module - Single Point</b> 60,000/90,000psi-4.100/6.200 bar 24V DC, 3 amp</p>	10146363	
<p> <b>Inlet Pressure Switch, 2 bar</b> 60,000/90,000psi-4.100/6.200 bar Stainless Steel</p>	05140751	
<p> <b>Valve Proportional Pressure Control</b> 60,000/90,000psi-4.100/6.200 bar</p>	80071087	
<p> <b>Proportional Control Assembly Kit</b> 60,000/90,000psi-4.100/6.200 bar Including Valve (80071087) and installation material</p>	05121987	
<p> <b>Directional Control Valve - Electric</b> 24V DC, D03, 4-way, 60,000psi/4.100 bar</p>	05017553	
<p> <b>Directional Control Valve Assembly, 24V DC, D08, 0.055 orifice</b> For SL-IV &amp; SL-V 60,000psi/4.100 bar - 30, 50, 60 horsepower intensifiers</p>	20437164	
<p> <b>Knob Adjuster</b> 60,000psi/4.100 bar. Used on all Hydraulic Cartridge Valve Assemblies Pressure Relief, 17-207 bar, SL-V, Classic and OEM units</p>	10187052	
<p> <b>Water Modulating Valve, 60,000psi/4.100 bar</b></p>	10091866	

All dimensions in inch unless specified otherwise.

Order online 24/7: [kmtgenuineparts.com](http://kmtgenuineparts.com)

## LIGHT BULBS

### DESCRIPTION



**Light Bulb 24V, 2.0 Watt**

60,000/90,000psi-4.100/6.200 bar. For use with Klockner Moeller Switches



**Light Bulb 24V AC/DC**

60,000/90,000psi-4.100/6.200 bar

For AB 800F

### PART No.

05050216



20484737



## PRESSURE TRANSDUCERS



**UHP Pressure Transducer**

0-90,000psi/0-6.200 bar



**Pressure Transducer**

0-75,000psi/0-5.200 bar



**PICO Fuse- Input/Output**

60,000/90,000psi-4.100/6.200 bar

20478335











49838478



49885866



# TOPWORKS TOOLS

	DESCRIPTION	PART No.
	<b>Hydraulic Tensioner Assembly, PRO Intensifier</b> 90,000psi/6.200 bar	20476132
	<b>Cylinder Clamp, PRO Intensifier</b> 90,000psi/6.200 bar	20476495
	<b>Vee Block Cradle</b> 60,000/90,000psi-4.100/6,200 bar	20484961
	<b>HP Seal Removal Tool</b>	
	0.88 Plunger, 60,000/90,000psi-4.100/6.200 bar	10148674
	1.13 Plunger, 60,000psi/4.100 bar	05146618
	<b>Plunger Removal Tool</b>	
	0.88 Plunger, 60,000/90,000psi-4.100/6.200 bar	20477460
	1.13 Plunger, 60,000psi/4.100 bar	20477469
	<b>Plate Glass Pane</b> 8.0 x 8.0 x 0.25	10149052
	<b>Emery Cloth</b> 320 Grit, 9.0 x 11.0 400 Grit, 9.0 x 11.0 600 Grit, 9.0 x 11.0	10149029 10149037 10149045



# TOPWORKS TOOLS

## DESCRIPTION

**Cylinder Wrench**

90,000psi/6.200 bar - PRO 2 Units

**Cylinder Wrench**

60,000psi/4.100 bar

**Crowfoot Wrench - 60,000psi/4.100 bar**

1.625, 0.38 drive

**HP Seal Removal Tool Stand**

60,000psi/4.100 bar

**End Cap Wrench**

60,000psi/4.100 bar, 6x/8x, HSEC

## PART No.

20490232

05066139

20477489

80078330

80079239



Check out the  
**OVER 200**  
**CUTTING VIDEOS**  
 on the **KMT**  
 YouTube Channel!



...and our other social media channels

# LUBRICANTS

## DESCRIPTION

60,000/90,000psi-4.100/6.200 bar Pumps

## PART No.



**Pure Goop Thread Lubricant**

1.0 pound

05026281



**Pure Goop Thread Lubricant**

1.0 ounce

10084440



**NLGI-2 Swivel Grease**

14.0 ounce

10067189



**FML-2 Grease - FDA Approved**

14.5 ounce

10087385



**Super-O-Lube O-Ring Grease**

0.07 ounce

20485968



**Threadlocker Adhesive**

242, 0.50 ML

20487868



**Threadlocker Primer**

1.75 ounce

20494983



**JL-M Thread Lubricant**

16.0 ounce

49832199



**Loctite Thread Lubricant**

8.0 ounce

1011919











## KMT SERVICE PLEDGE TO OUR CUSTOMERS

Our loyal customers are extremely important to the people that make up our sales and service teams.

Our accomplishments are measured by the highest quality of positive involvement we can provide before, during and after the purchase of our products.

By offering more value with consistent, favorable past and present experiences in every aspect of every interaction, we strive to continue to earn your faith, and gain new, loyal customers.



### **SINCE 1963, KMT HAS BEEN AT THE HEART OF ULTRA HIGH-PRESSURE (“UHP”) PUMP TECHNOLOGY.**

We specialize in the design and manufacture of waterjet cutting pumps and technology, and are dedicated to helping our global customers accelerate their businesses with ultra high-pressure. We're committed to pairing our cutting edge technology with impeccable service, so you can focus on growing your business.

### **KMT. A GLOBAL FORCE IN WATERJET TECHNOLOGY**

### **BACKED BY KMT PREVENTIVE MAINTENANCE PROGRAMS**

Our Global KMT Genuine Service Engineers are highly qualified, averaging 15+ years of waterjet experience.



[kmtgenuineparts.com](http://kmtgenuineparts.com)

KMT Waterjet Systems Inc.  
635 West 12th Street | Baxter Springs | KS 66713  
800 826 9274 | [kmtwaterjet.com](http://kmtwaterjet.com)

