

Abrasive Cutting Nozzle AUTOLINE™

High Speed, Self-aligning, Cutting Nozzle

Independent tests have shown the AUTOLINE™ Abrasive Cutting Nozzle cuts faster and at a lower cost than any other nozzle.

Convenient, Modular Design

Unlike other nozzles, the AUTOLINE™ is a modular nozzle. The orifice, mixing chamber and focusing tube were designed as separate parts which can be replaced independently as needed, reducing costs.

Simpler, Self-aligning Components

These self-aligning components of the AUTOLINE™ require no tools to change the orifice. It literally takes seconds to perform the quick, quarter-turn of the nozzle to remove the orifice (abrasive line stays attached). Once reassembled, the nozzle is right back to the Tool Center Point - without machine realignment. All changes can be made quickly, without tools. The AUTOLINE™ can also be completely removed (without tools) to allow cutting with water only.

Proven to be Best

Tests performed by the University of Missouri-Rolla, showed the AUTOLINE™ Cutting Nozzle achieved best overall cutting performance. Fast cutting and low abrasive consumption helped it to win the top position. With the AUTOLINE™, there is no need for an expensive, tilting cutting head. AUTOLINE™ is fast, precise - the best operating value.

The net result is an outstanding nozzle that delivers a sharper, more coherent, cutting stream for faster cutting while using less abrasive. AUTOLINE™ is the best, most precise option.

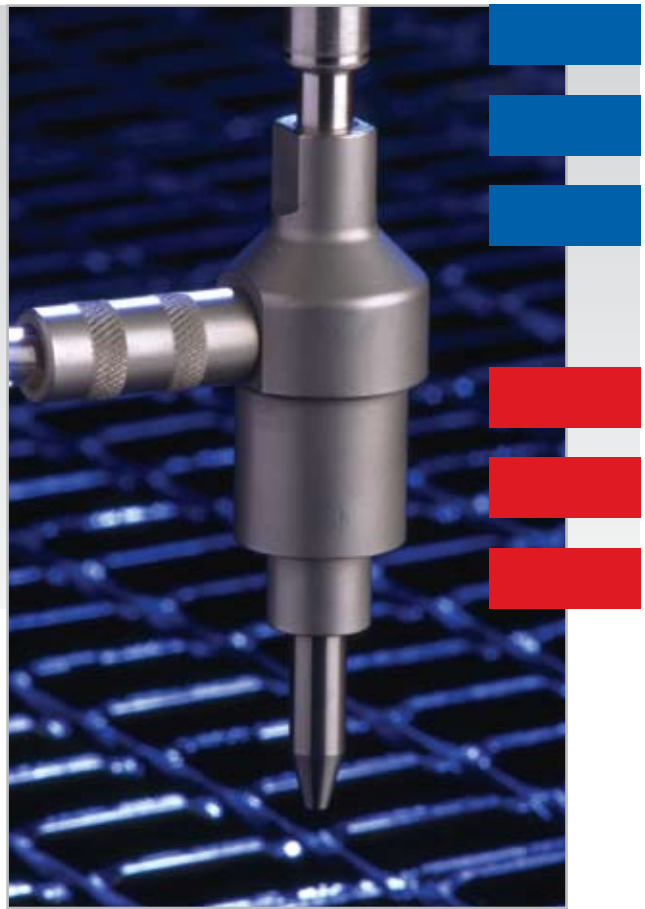

The AUTOLINE™ was designed to work with the complete line of KMT Waterjet cutting head components and the new STREAMLINE™ SL-V line of pumps. This new line of pumps is available in more sizes and with state-of-the-art features.

Please call to discuss your applications or to receive more information on any high pressure component. KMT Waterjet has a network of trained and certified technicians available to provide Cutting Edge Solutions.

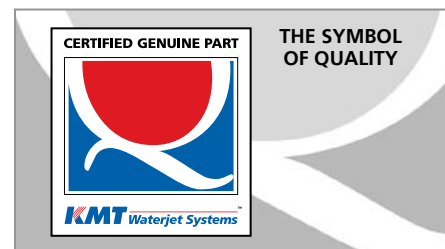



Operating Cost Analysis of Abrasive Cutting Nozzles

Comparison made using identical operating conditions

Test results provided by Missouri-Rolla

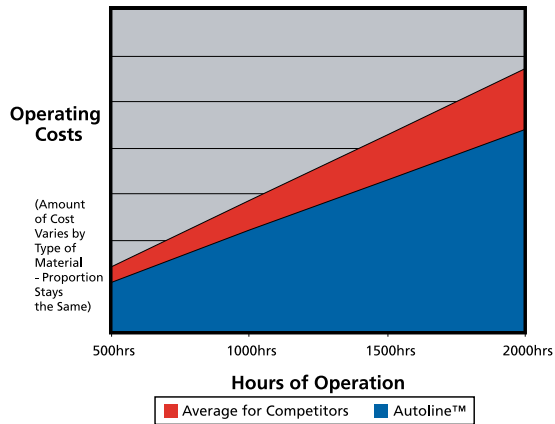

Summary of Features

- Modular design best for lowest operating cost.
- Self-aligning design retains the Tool Center Point to provide more machine time
- Tighter alignment with the orifice extends the life of consumable parts
- Tool-free, hand-tightening design of the nozzle is faster to install and protects the orifice
- Tighter waterjet stream increases cutting speed while using less abrasive
- Lightweight, compact design integrates with any high-pressure system
- Natural diamond orifice is standard and delivers maximum life

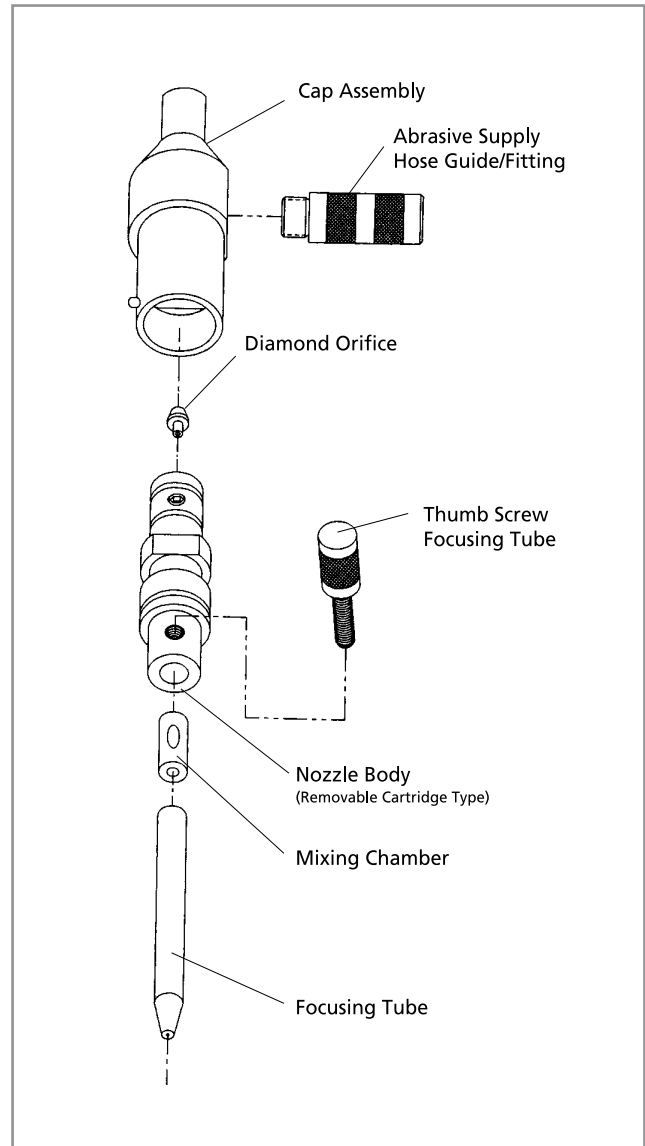

Authorized Representative:

9080-101



KMT Waterjet Systems, Inc.

635 W. 12th Street • P.O. Box 231 • Baxter Springs, KS 66713
 Tel.: 1-620-856-2151 • Fax: 1-620-856-5050
www.kmtwaterjet.com • sales@kmtwaterjet.com